

TEDH F400 - TEDV F400

CENTRIFUGAL BACKWARD IMPELLER

- F400 120 certified (400°C 120 min), with inverter or control panel
- Optimal performances: efficiency, consumption, sound level, pressure
- IE3 motor option
- Airflow range from 200 up to 34 000m³/h
- Possible setting near to a wall by closing a side
- Control panel fitted and wired on both arrangements
- Running up to 120°C continuous airflow



NRVU
 Comfort application variable speed drive compulsory
 Comfort/smoke extract applications variable speed drive not compulsory



Application

- Comfort application
- High towers and public buildings smoke extraction
- Technical and industrial applications
- Professional kitchens

- Smoke and hot gazes extraction in case of fire.
- Comfort and industrial applications polluted air extraction.
- Professional kitchen pollutants extraction.
- Max. temp of extract air in continuous airflow: 120°C.

Range

- **TEDH F400 arrangement : horizontal discharge.**
- **TEDV F400 arrangement : vertical discharge.**
 - Non visible motor and fan.
 - Minimum clogging around the product itself.
 - Improved protection against water inlet.
- 15 sizes : 250 / 315 / 355 / 400 / 450 / 500 / 560 / 630 / 695 / 710 / 760 / 810 / 800B / 800H / 900.
- Airflow from 200 up to 34 000 m³/h.
- With INTZ (safety switch) or with INTZ + BDEZ (pressure switch).
- Without INTZ upon request.

F400 certified accessories

	SILS Basis sound attenuator		TCDZ 05 Adaptation plate with circular flange
	TCDZ 01 Standard support		TCDZ 06 Tipping-up kit
	TCDZ 02 Embedding frame		TCDZ 08 Roof adapter heightener
	TCDZ 03 Non-return flaps		TCDZ 09 Straight roof adapter with sound attenuator
	TCDZ 04 and 07 Horizontal and sloping roof adapters		POPM Closing plate for setting alongside a wall

F400 certified options

	INTZ external lockable safety switch		PILOTAIR® Fitted and wired control panel according to NF S61-932 regulation
	BDEZ Pressure switch		VFTM VFTM PR Frequency inverter

TEDH F400



TEDV F400

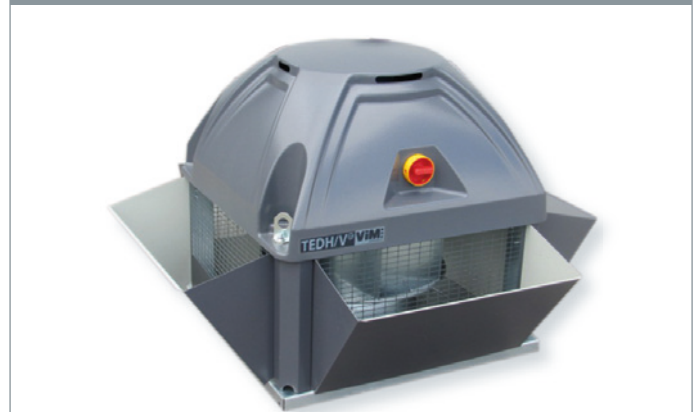

TEDV + PILOTAIR®



Delivered with lifting slings



TEDH + POPM



Certifications

F400 120 certified (400°C 120 min) according to European standard NF EN 12101-3.
 CE conformity marking : 1812-CPR-1085

EXTRACTION ROOF FAN

TEDH F400 - TEDV F400

CENTRIFUGAL BACKWARD IMPELLER

Description

Construction :

- Galvanized steel high performance backward fan.
- Convergent/divergent inlet cones for airflow optimization, higher efficiency and reduced sound level.
- Direct coupling on fan shaft.
- Galvanized steel plate, frame and motor support.
- 2 or 4 lifting slings according to size.
- RAL 7024 grey lacquered support covers :
 - Nice smoke extractor finish
 - Easy set down to access to the unit fixing points.
 - Unit inlet wire hidden and protected.
- RAL 7024 grey lacquered machined galvanised steel guards, mesh according to NF EN ISO 12499 standard.
- ABS PMMA grey RAL 7024 roof :
 - Valuable body.
 - Harmonious external isolator integration.
 - Motor and pressure switches protection.
 - High weatherproof and UV-proof capacities.
 - Shock resistant.
- Vertical arrangement : 4 RAL 7024 lacquered steel air deflectors set in factory (TEDV F400 type) or available as a kit for assembling on site (KRVT).

Paint :

- Polyester paint RAL 7040 finish, casing and fan, on both faces. Grease removed + zinc phosphated + 60 µm paint.
- Other colours, other treatment : please consult us

Motorization :

- Standard B5 flange motor, IP55, F class.
- PTO thermal protection (normally closed thermostat) as an option.
- One phase 230V 50Hz 1 speed 2, 4 or 6 poles, (speed variation allowed with voltage variator).
- Three-phase 230/400V 50Hz 1 speed 2, 4, 6 or 8 poles, IE1, IE2 or IE3 (frequency inverter allowed).
- Three-phase 400V 50Hz 2 speeds 4/6, 4/8, 6/8 or 6/12 poles.
- Motor options :
 - Three-phase 230/400V 50Hz IE3 1 speed, smoke extract and comfort applications, F400-120 certified, please consult us.
 - Three-phase IE4 1 speed, comfort application only, please consult us.
 - 60 Hz supply : F400 120 certified with VFTM option fitted and wired in factory : 60Hz inlet inverter supply and 50Hz outlet inverter for fan supply.

F400 120 certified electrical equipments fitted in factory

- C1-CR1 wire protected with a UV-proof soft external case.
- INTZ external lockable safety isolator switch as a standard : soberly fitted below the roof, only the rotative switch can be seen and high weatherproof capacities.
- BDEZ pressure switch : set below the roof and airflow connected to spare time during setting.



PILOTAIR® control panel (French regulation) :

- According to sizes, see page 566, the control panel can be provided fitted and wired on a closing plate, hood protected.
- For all sizes, it can be provided as an accessory or only wired, wiring codes page 566. Setting accessories SMCR/STCR (see page 670), enable to set at more than 1.5 m of the roof fan (away from the discharging area).

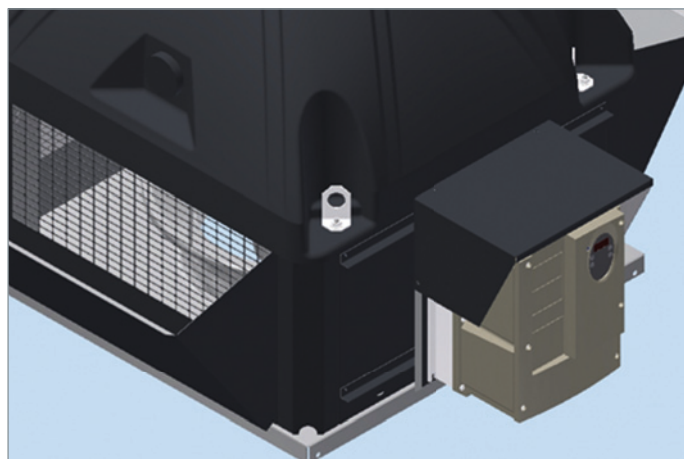

- VFTM : frequency inverter, with remote control option, fitted and wired on a side closing plate (available on both TEDH F400 and TEDV F400 arrangements). Use example : extract fan with remote control CVF set in a kitchen.
- VFTM-PR : option «pressure regulated». The PR arrangement allows a constant pressure regulation thanks to a pressure switch set upstream.

Non certified electrical accessories

- DEMZ : 2 speeds starter,
- DIJZ/DIJP : 1 speed circuit breaker
- VARZ : mono voltage speed variator.
- Other frequency inverters: VFKB, VFTE.

Those accessories cannot be set on the unit.

Setting accessories TCDZ 01 up to 09, SILS sound attenuator, POPM side closing plate, KRVT vertical outlet kit.

- All accessories are included in F400 120 certification.
- POPM : side closing plate for TEDH setting close from a wall (or nearby a gas extraction obstacle). Allow a good space saving and to avoid direct dust projection onto the wall.
- Laboratory tests proved that the vertical outlet kit and the closing plate on one side have no effects on air, sound or electrical specifications of the smoke extraction fan.

EXTRACTION ROOF FAN

TEDH F400 - TEDV F400

CENTRIFUGAL BACKWARD IMPELLER

Description (mm)

TEDH F400

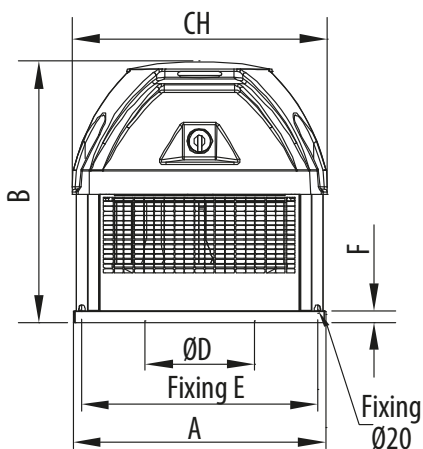

Fitted&wired PILOTAIR® option

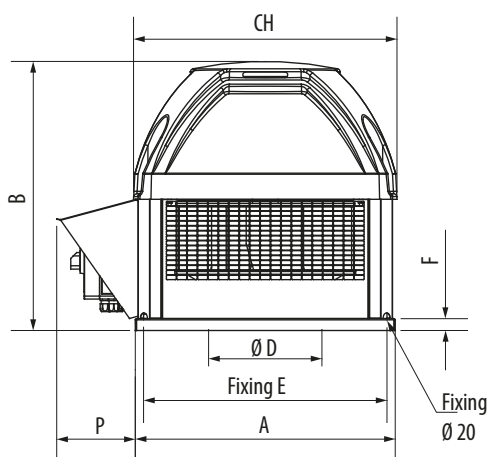

Size	A	B	CH	E	F	P	D	Weight H (kg)
250	430	446	436	344	30	105	214,0	18
315	430	483	436	344	30	125	256,6	21
355	540	570	553	450	30	146	289,1	28
400	540	609	553	450	30	169	325,8	33
450	660	684	669	570	30	190	366,5	55
500	660	698	669	570	30	198	407,3	60
560	800	762	817	668	30	209	455,2	81
630	800	805	817	668	30	234	513,1	83
695	946	918	957	830	30	173	541,0	105
710	946	1096	957	830	40	273	577,9	156
760	946	940	957	830	30	187	596,0	125
810	946	983	957	830	40	204	650,9	145
800B	946	1114	957	830	40	284	650,9	193
800H	946	1172	957	830	40	317	646,0	203
900	1250	1253	1262	1100	62	315	732,3	316

Description (mm)

TEDV F400

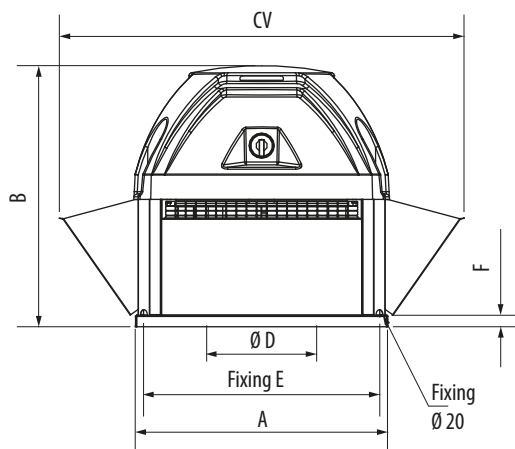

Fitted&wired PILOTAIR® option

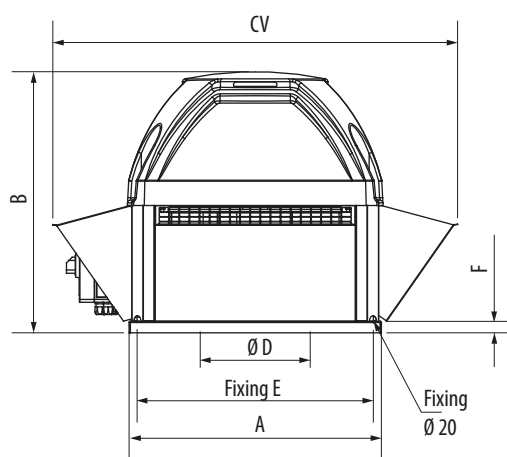

Size	A	B	CV	E	F	D	Weight V (kg)
250	430	446	635	344	30	214,0	20
315	430	483	680	344	30	256,6	24
355	540	570	832	450	30	289,1	34
400	540	609	878	450	30	325,8	40
450	660	684	1038	570	30	366,5	64
500	660	698	1055	570	30	407,3	74
560	800	762	1219	668	30	455,2	92
630	800	805	1268	668	30	513,1	96
695	946	918	1291	830	30	541,0	124
710	946	1096	1492	830	40	577,9	174
760	946	940	1319	830	30	596,0	146
810	946	983	1352	830	40	650,9	169
800B	946	1114	1512	830	40	650,9	215
800H	946	1172	1580	830	40	646,0	224
900	1250	1253	1874,8	1100	62	732,3	342

EXTRACTION ROOF FAN

TEDH F400 - TEDV F400

CENTRIFUGAL BACKWARD IMPELLER

Smoke extraction fans

Accessories range

TEDH F400

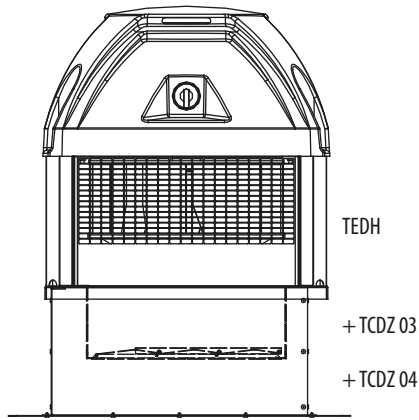

TEDV F400

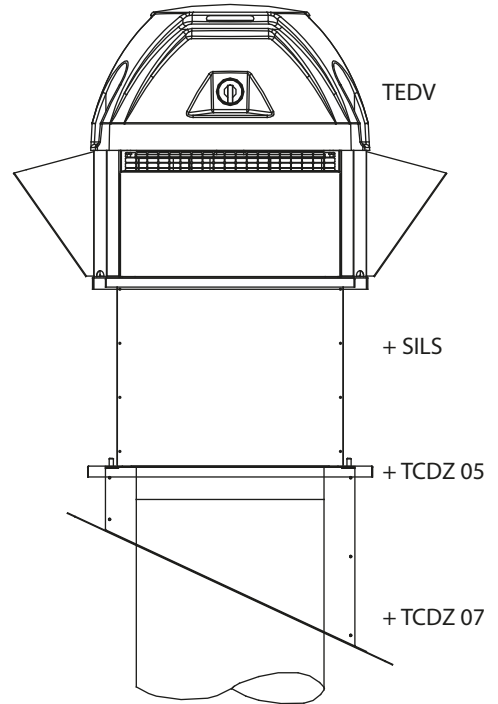

KRVT : Vertical outlet kit

To turn a TEDH F400 into a TEDV F400, including 4 steel deflectors, RAL 7024 grey painted.

TEDH F400 with PILOTAIR®



TEDH F400



TEDV F400

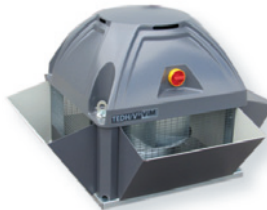

TEDV F400 with PILOTAIR®

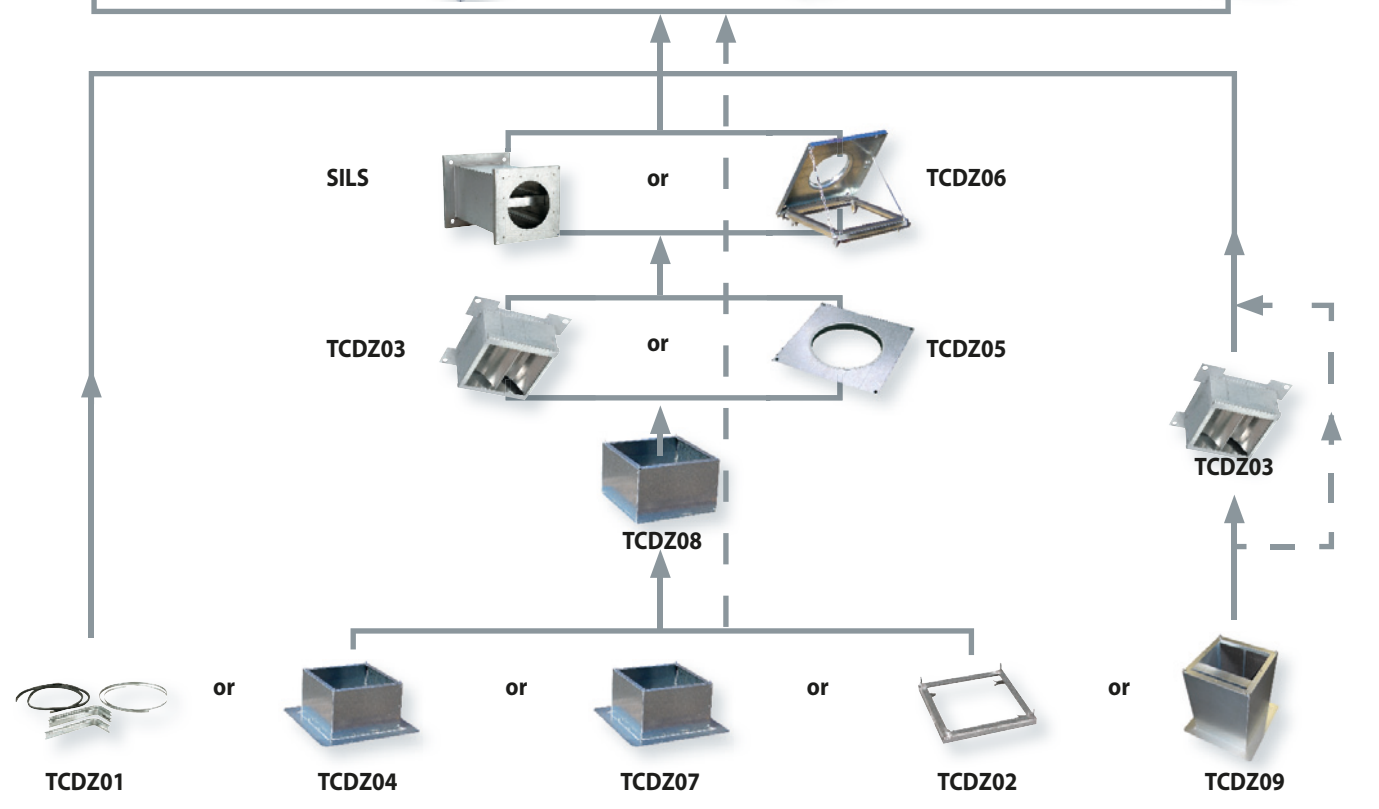

--- Optional accessory according to the selection

EXTRACTION ROOF FAN

TEDH F400 - TEDV F400

CENTRIFUGAL BACKWARD IMPELLER

Dimensions (mm)

Accessories

TCDZ 01 : standard support

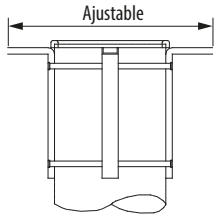

TCDZ 02 : embedding frame

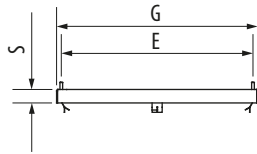

TCDZ 03 : non-return flaps

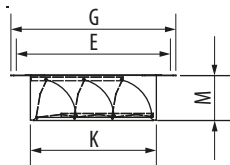

TCDZ 04 : horizontal roof adapter

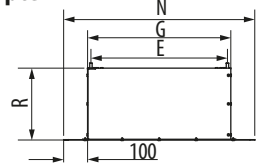

TCDZ 04 : insulated horizontal roof adapter

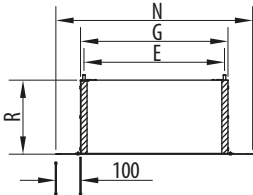

TCDZ 07 : sloping roof adapter

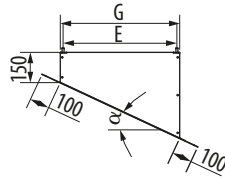

TCDZ 07 : insulated sloping roof adapter

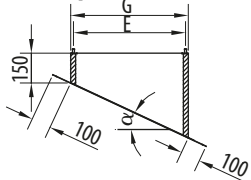

TCDZ 08 : roof adapter heightener

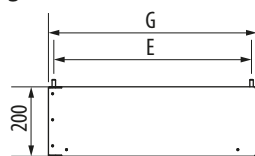

Size	Accessorie size	Dimensions						
		E	G	K	N	M	R	S
250/315	1	344	368	300	568	145	300/500/700	30
355/400	2	450	478	400	678	145	300/500/700	30
450/500	3	570	598	490	798	170	300/500/700	40
560/630	4	668	698	605	898	170	300/500/700	40
695/710/760 810/800B/800H	5	830	866	730	1066	190	300/500/700	40
900	7	1100	1150	970	1350	190	300/500/700	65

Size	Accessorie size	Weight (kg)				
		TCDZ 01	TCDZ 02	TCDZ 03	TCDZ 04	TCDZ 08
250/315	1	3	2	3,5	8,5/12/15,5	4,8
355/400	2	3	2,5	5	11/15,5/20	6,2
450/500	3	4	4	6	13,5/19/25	10,5
560/630	4	4	4,5	8	20,5/29,5/38	12,2
695/710/760 810/800B/800H	5	6	6	11	25,5/37/48	15
900	7	12	12	24	53/76/98	31,4

TCDZ 07

Size	Accessorie size	Weight (kg)									
		According to adapter angle									
		5°	10°	15°	20°	25°	30°	35°	40°	45°	
250/315	1	6,7	6,7	7	7,4	7,7	8,2	8,7	9,2	9,9	
355/400	2	8,7	8,7	9,2	9,8	10,3	11,2	12	12,9	13,9	
450/500	3	11	11	11,9	12,7	13,7	14,8	16	17,3	19	
560/630	4	17,4	17,4	18,9	20,2	22,3	24,2	26,3	28,7	31,6	
695/710/760 810/800B/800H	5	22,4	22,4	24,7	27	29,6	32,4	35,6	39,3	43,5	
900	7	49,5	49,5	55,6	62	69,6	77,2	85,7			

Dimensions (mm)

TCDZ 05 : circular flange adapting plate

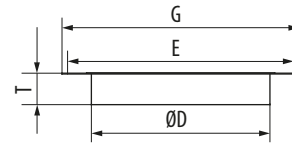

Size	Acces. size	Dimensions					Weight (kg)
		G	E	T	ØD		
250/315	1	368	344	50	250	1	
250/315	1	368	344	50	315*	0,7	
250/315	1	368	344	65	355*	0,4	
355/400	2	478	450	50	315	1,8	
355/400	2	478	450	65	355	1,5	
355/400	2	478	450	80	400	1,2	
355/400	2	478	450	80	450*	0,8	
450/500	3	598	570	80	400	3,6	
450/500	3	598	570	80	450	3,1	
450/500	3	598	570	80	500	2,5	
450/500	3	598	570	80	560*	1,7	
560/630	4	698	668	80	450	5,1	
560/630	4	698	668	80	500	4,5	
560/630	4	698	668	80	560	3,7	
560/630	4	698	668	90	630	2,7	
695/710/760/810/800B/800H	5	866	830	80	560	11,8	
695/710/760/810/800B/800H	5	866	830	90	630	10,3	
695/710/760/810/800B/800H	5	866	830	120	710	8,3	
900	7	1150	1100	120	710	21,8	

* : those adapting plate are not suitable with following accessories TCDZ 02, TCDZ 04, TCDZ 07 and TCDZ 08

TCDZ 06 : tipping-up kit

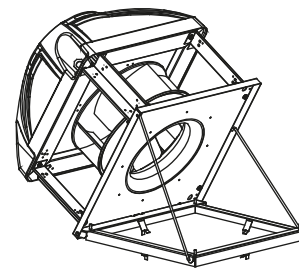

- Allow fan and duct cleaning.
- 60° Rotating on an embedding frame, hold by a safety chain and rod.
- Airtightness seal provided.
- Can be set on flat roof adapter TCDZ04.

Size	Accessories size	Weight (kg)
250/315	1	1,5
355/400	2	2
450/500	3	2,5
560/630	4	3
695/760/810	5	3,5

TEDH F400 - TEDV F400

CENTRIFUGAL BACKWARD IMPELLER

Smoke extraction fans

Dimensions (mm)

Accessories

SILS : sound attenuator basis

TCDZ 09 : straight roof adapter + sound attenuator

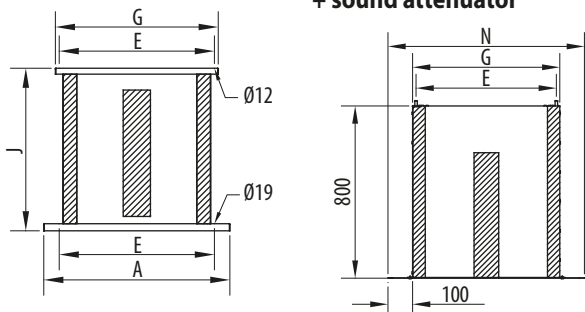

Models	Accessorie size	Dimensions					Weight (kg)	
		A	E	G	J	N	SILS	TCDZ 09
250/315	1	430	344	368	630	568	15	23,5
355/400	2	540	450	478	630	678	23	34
450/500	3	660	570	598	700	798	37	51
560/630	4	800	668	698	700	898	45	65,5
695/710/760 810/800B/800H	5	930	830	866	700	1066	65	90,5
900	7	1250	1100	1150	800	1350	111	164

Air performances

SILS Size 1 to 4

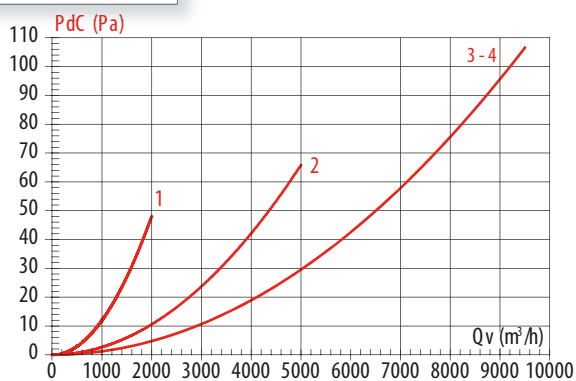

SILS Size 5 to 7

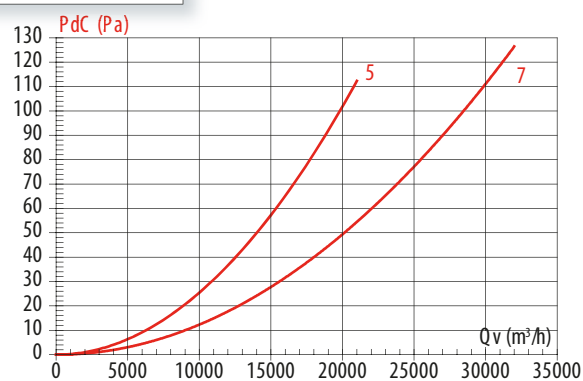

TCDZ 09 Size 1 to 3

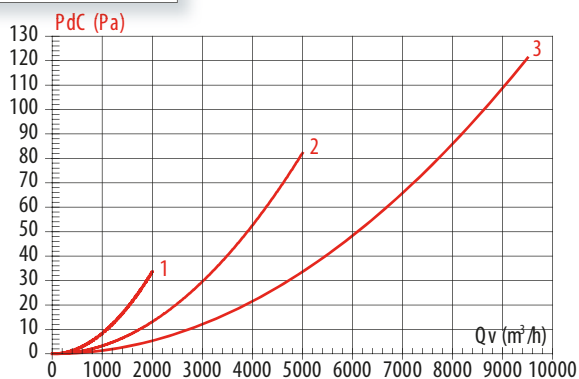

TCDZ 09 Size 4 to 7

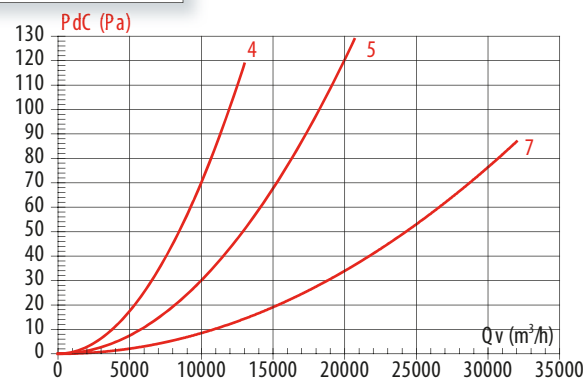

Acoustic data

Noise attenuation

SILS

Size	Frequencies*							Total Lw (A)	
	63	125	250	500	1000	2000	4000		8000
1	3	9	10	14	21	17	13	11	21
2	3	9	10	14	21	17	13	11	21
3	3	9	10	14	21	17	13	11	21
4	3	12	13	21	26	23	16	13	27
5	3	12	13	21	26	23	16	13	27
7	1	3	6	14	18	17	10	5	22

* According to NF EN ISO 7235 standard

TCDZ 09

Size	Frequencies*							Total Lw (A)	
	63	125	250	500	1000	2000	4000		8000
1	0	1	5	10	24	27	16	8	30
2	1	3	7	12	26	29	18	10	32
3	1	3	7	12	26	29	18	10	32
4	1	3	6	12	21	24	15	7	27
5	1	3	6	13	19	22	13	7	25
7	1	3	6	14	18	17	10	5	22

* According to NF EN ISO 7235 standard

EXTRACTION ROOF FAN

TEDH F400 - TEDV F400

CENTRIFUGAL BACKWARD IMPELLER

Air performances

TEDH/TEDV F400 range

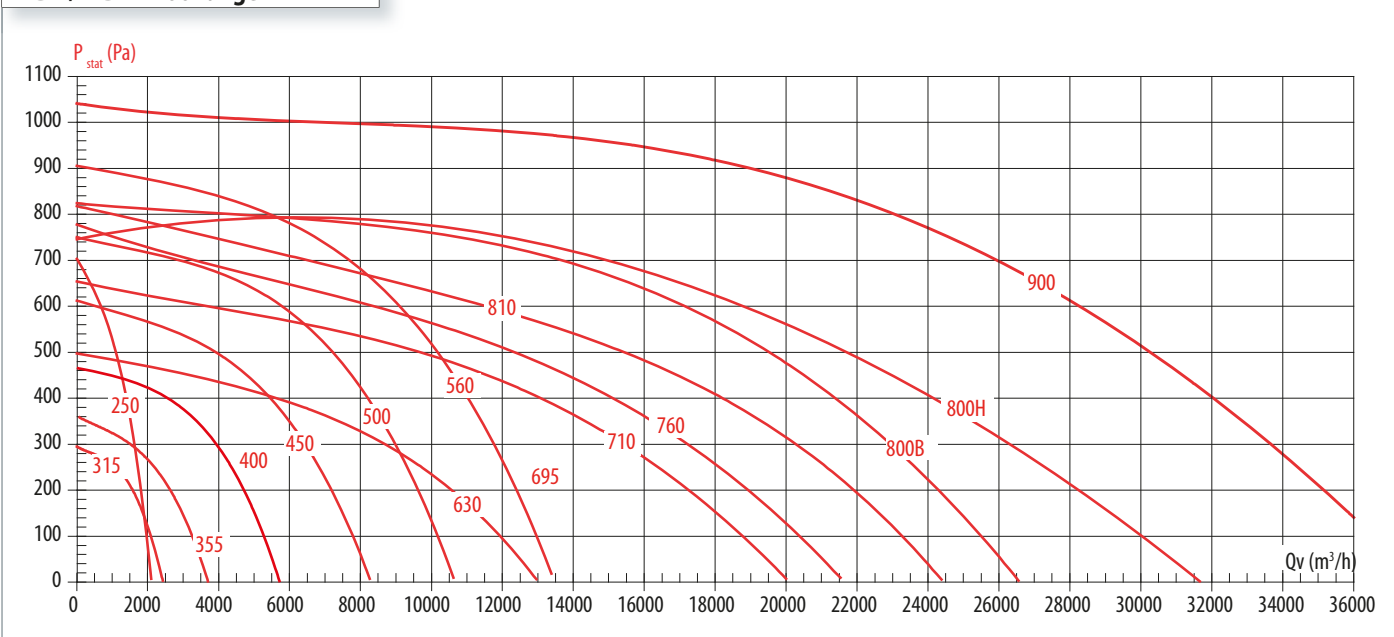

Refurbishing – After-Sales services

The TEDH F400 - TEDV F400 range is fully exchangeable with the TCDH F400 - TCDV F400 range.

During refurbishing or after-sales operations, it is possible to set a new unit on the fixing points of the previous one, **without any change, keeping all accessories already set** (roof adapter, tipping – up kit, non-return flaps).

Opposite board shows setting possibilities according to sizes. Air performances of the new unit should be check afterwards (refer to graph here below).

Fixing dimensions	Setting equivalence	
	Old TCDH F400-TCDV F400	New TEDH F400-TEDV F400
344x344	010	250
	020	315
450x450	030	355
	040	400
570x570	060	450
	080	500
668x668	105	560
	110	630
	140	695
	195	710 / 760
830x830	250	810 / 800B / 800H

TEDH/TEDV - TCDH/TCDV comparison

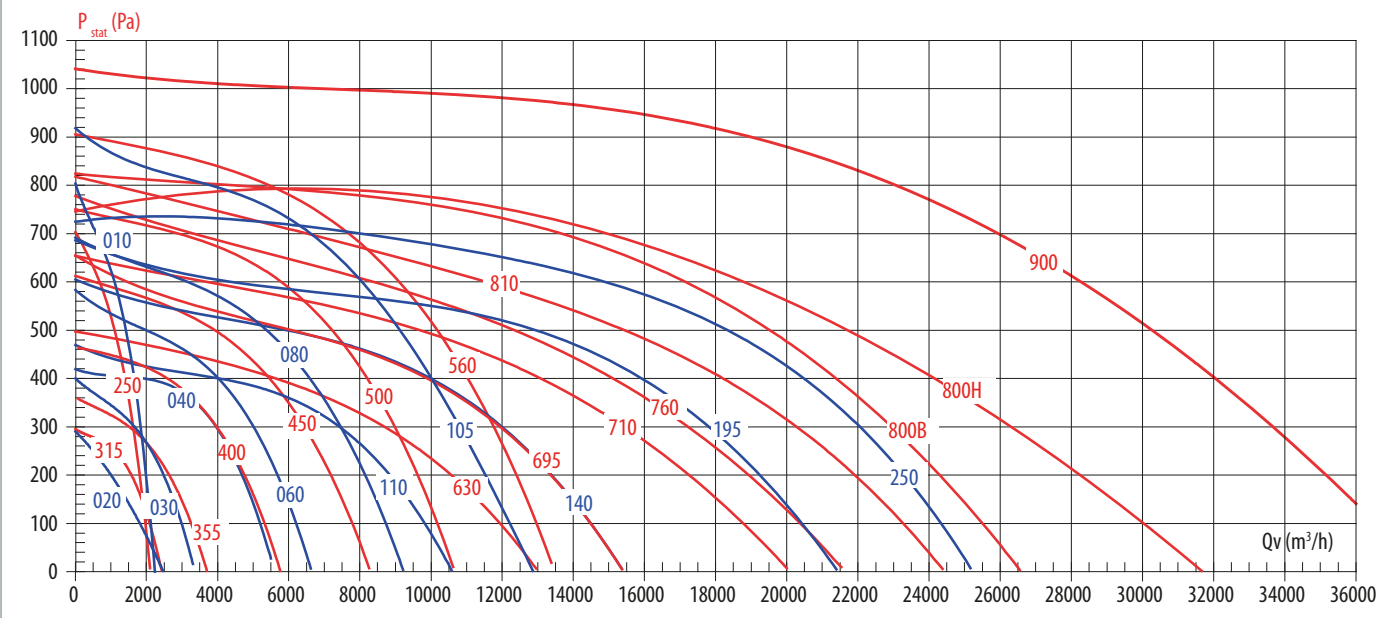

EXTRACTION ROOF FAN

TEDH F400 - TEDV F400

CENTRIFUGAL BACKWARD IMPELLER

Air performances

According to ISO 5801 standard, with 1,2 kg/m³ air density.
 NOTA : for units with non-return flaps (TCDZ 03), take in account 50 Pa pressure drop.

○ Sound pressure level checked in hemispheric free field ; on a reflecting plate ; the microphone is located at 6 meters from sound source. Air inlet connected ; Lp (dB (A)).

□ Sound power level radiated in the inlet cylindrical pipe ; Lw (dB (A)).

$$SFP = \frac{P}{Q_v} \quad P = \text{absorbed (W)} ; Q_v = \text{air flow (m}^3/\text{s)} ; SFP = \text{W/m}^3 \cdot \text{s}^{-1}$$

SFP classification page 1382

REFERENCE :

N°1 : Radiated sound power level Lw (dB) in inlet duct according to NF EN ISO 5136 standard.

N°2 : Radiated sound power level Lw (dB) outside according to NF EN ISO 3746 standard.

TEDH F400 250
TEDV F400 250

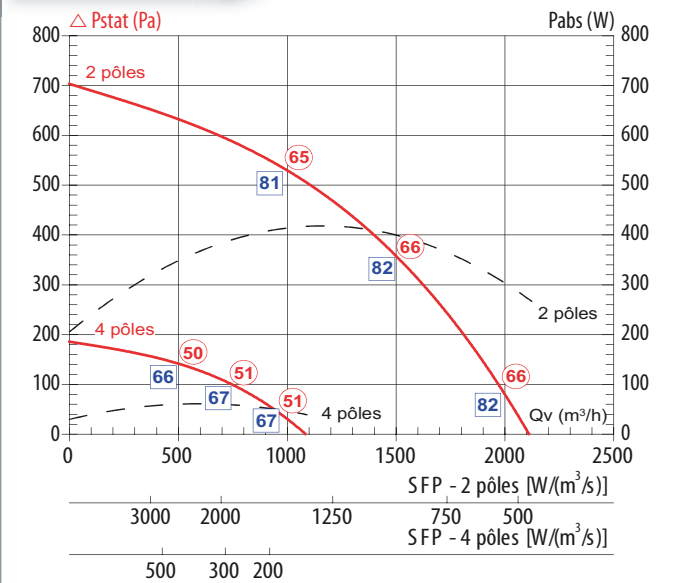

Frequency (Hz)		63	125	250	500	1K	2K	4K	8K	
2 poles	2050 m ³ /h	N°1	73	74	81	79	74	75	75	71
		N°2	74	76	82	86	84	84	80	75
	1500 m ³ /h	N°1	71	73	80	79	74	75	74	70
		N°2	72	75	80	85	84	83	79	74
	1000 m ³ /h	N°1	68	72	79	80	74	74	73	69
		N°2	70	74	81	85	84	83	79	73
4 poles	1000 m ³ /h	N°1	58	59	66	64	59	60	60	56
		N°2	59	61	67	71	69	69	65	60
	750 m ³ /h	N°1	56	58	65	64	59	60	59	55
		N°2	57	60	65	70	69	68	64	59
	500 m ³ /h	N°1	53	57	64	65	59	59	58	54
		N°2	55	59	66	70	69	68	64	58

TEDH F400 315
TEDV F400 315

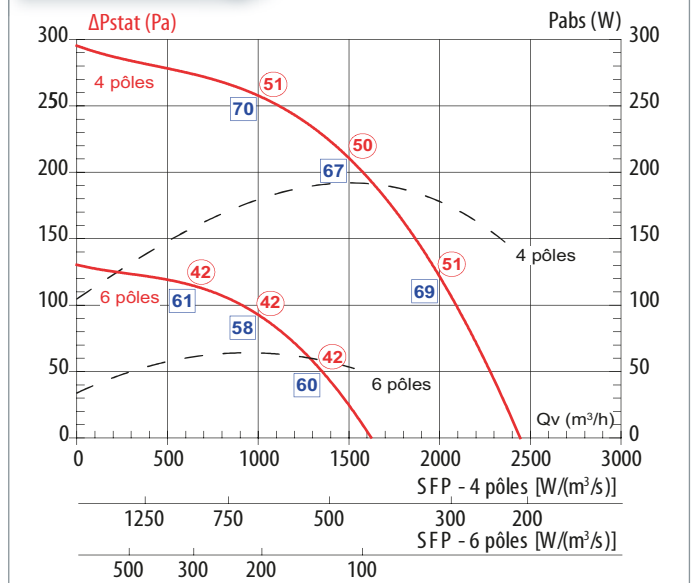

Frequency (Hz)		63	125	250	500	1K	2K	4K	8K	
4 poles	2050 m ³ /h	N°1	55	64	63	63	61	66	58	51
		N°2	56	73	68	68	69	69	63	55
	1500 m ³ /h	N°1	55	66	64	64	61	61	57	51
		N°2	58	73	68	68	70	67	61	55
	1000 m ³ /h	N°1	68	73	70	69	62	60	56	50
		N°2	69	75	70	70	71	67	60	53
6 poles	1300 m ³ /h	N°1	46	55	54	54	52	57	49	42
		N°2	47	64	59	59	60	60	54	46
	1000 m ³ /h	N°1	46	57	55	55	52	52	48	42
		N°2	49	64	59	59	62	58	52	46
	600 m ³ /h	N°1	59	64	61	60	53	51	47	41
		N°2	60	66	61	61	62	58	51	44

- : Lp dB (A) free field at 6 m
- : Lw dB (A) duct radiated
- N°1 : Lw dB duct radiated
- N°2 : Lw en dB free field

Poles	2	4	6	8	12
Fan speed (rpm)	3000	1500	1000	750	500

EXTRACTION ROOF FAN

TEDH F400 - TEDV F400

CENTRIFUGAL BACKWARD IMPELLER

Air performances

TEDH F400 355
TEDV F400 355

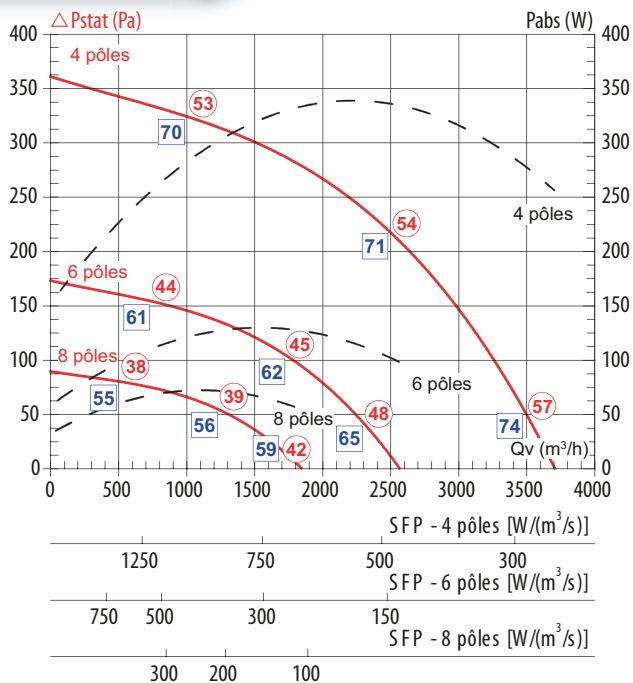

Frequency (Hz)	63	125	250	500	1K	2K	4K	8K		
4 poles										
Curve	Airflows	Ref.	Spectrum dB							
4 poles	3500 m³/h	N°1	59	68	68	67	65	71	63	55
		N°2	63	78	73	74	73	77	70	60
	2500 m³/h	N°1	59	70	68	68	65	65	61	54
		N°2	60	76	71	71	75	70	64	57
1000 m³/h	N°1	68	73	70	69	62	60	56	50	
	N°2	79	82	76	74	72	68	62	55	
6 poles										
Curve	Airflows	Ref.	Spectrum dB							
6 poles	2250 m³/h	N°1	50	59	59	58	56	62	54	46
		N°2	54	69	64	65	64	68	61	51
	1750 m³/h	N°1	50	61	59	59	56	56	52	45
		N°2	51	67	62	62	66	61	55	48
600 m³/h	N°1	59	64	61	60	53	51	47	41	
	N°2	70	73	67	65	63	59	53	46	
8 poles										
Curve	Airflows	Ref.	Spectrum dB							
8 poles	1750 m³/h	N°1	44	53	53	52	50	56	48	40
		N°2	48	63	58	59	58	62	55	45
	1250 m³/h	N°1	44	55	53	53	50	50	46	39
		N°2	45	61	56	56	60	55	49	42
500 m³/h	N°1	53	58	55	54	47	45	41	35	
	N°2	64	67	61	59	57	53	47	40	

TEDH F400 400
TEDV F400 400

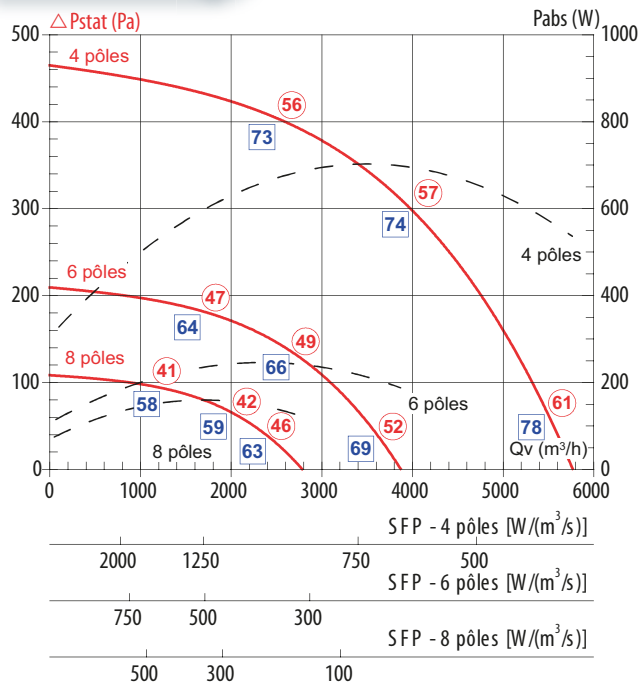

Frequency (Hz)	63	125	250	500	1K	2K	4K	8K		
4 poles										
Curve	Airflows	Ref.	Spectrum dB							
4 poles	5500 m³/h	N°1	62	77	73	67	67	75	71	61
		N°2	68	82	79	77	76	81	76	66
	4000 m³/h	N°1	69	75	74	68	67	69	65	58
		N°2	66	80	76	74	74	76	72	63
2500 m³/h	N°1	81	82	76	71	66	64	59	55	
	N°2	76	85	79	76	74	72	67	61	
6 poles										
Curve	Airflows	Ref.	Spectrum dB							
6 poles	3750 m³/h	N°1	53	68	64	58	58	66	62	52
		N°2	59	73	70	68	67	72	67	57
	2750 m³/h	N°1	61	67	66	60	59	61	57	50
		N°2	57	71	67	65	65	68	63	55
1750 m³/h	N°1	72	73	67	62	57	55	50	46	
	N°2	68	76	71	67	65	63	58	52	
8 poles										
Curve	Airflows	Ref.	Spectrum dB							
8 poles	2500 m³/h	N°1	47	62	58	52	52	60	56	46
		N°2	53	67	64	62	61	66	61	51
	2000 m³/h	N°1	54	60	59	53	52	54	50	43
		N°2	51	65	61	59	59	61	57	48
1000 m³/h	N°1	66	67	61	56	51	49	44	40	
	N°2	62	70	65	61	59	57	52	46	

- : Lp dB (A) free field at 6 m
- : Lw dB (A) duct radiated
- N°1 : Lw dB duct radiated
- N°2 : Lw en dB free field

Poles	2	4	6	8	12
Fan speed (rpm)	3000	1500	1000	750	500

EXTRACTION ROOF FAN

TEDH F400 - TEDV F400

CENTRIFUGAL BACKWARD IMPELLER

Smoke extraction fans

Air performances

TEDH F400 450
TEDV F400 450

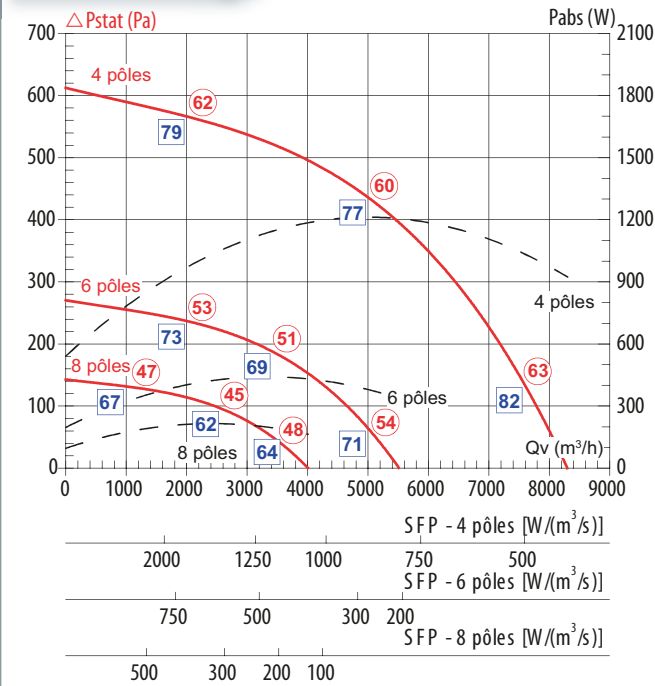

Frequency (Hz)		63	125	250	500	1K	2K	4K	8K		
4 poles	7500 m ³ /h	N°1	65	80	76	71	70	78	75	65	
		N°2	69	86	83	81	79	81	78	70	
	5000 m ³ /h	N°1	72	79	77	71	70	72	68	62	
		N°2	72	84	82	79	78	77	73	67	
	2000 m ³ /h	N°1	87	88	82	77	71	70	65	61	
		N°2	88	91	86	82	81	76	71	66	
	6 poles	5000 m ³ /h	N°1	56	71	67	62	61	69	66	56
			N°2	60	77	74	72	70	72	69	61
		3000 m ³ /h	N°1	63	70	68	62	61	63	59	53
			N°2	63	75	73	70	69	68	64	58
		2000 m ³ /h	N°1	78	79	73	68	62	61	56	52
			N°2	79	82	77	73	72	67	62	57
8 poles	3500 m ³ /h	N°1	50	65	61	56	55	63	60	50	
		N°2	54	71	68	66	64	66	63	55	
	2500 m ³ /h	N°1	57	64	62	56	55	57	53	47	
		N°2	57	69	67	64	63	62	58	52	
	1000 m ³ /h	N°1	72	73	67	62	56	55	50	46	
		N°2	73	76	71	67	66	61	56	51	

- : Lp dB (A) free field at 6 m
- : Lw dB (A) duct radiated
- N°1 : Lw dB duct radiated
- N°2 : Lw en dB free field

TEDH F400 500
TEDV F400 500

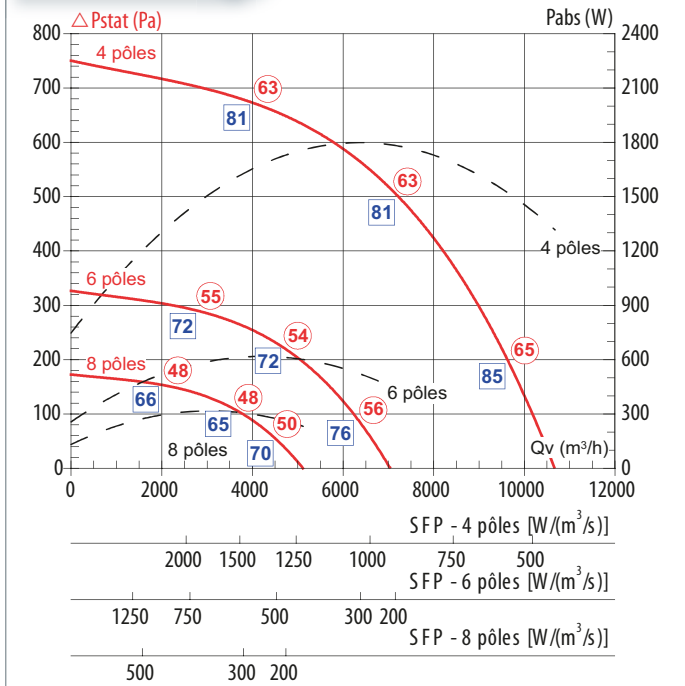

Frequency (Hz)		63	125	250	500	1K	2K	4K	8K		
4 poles	9500 m ³ /h	N°1	70	84	82	75	75	81	73	66	
		N°2	75	90	88	84	83	81	78	71	
	7000 m ³ /h	N°1	67	82	81	73	74	75	71	65	
		N°2	74	90	86	83	81	79	75	70	
	4000 m ³ /h	N°1	81	88	84	75	74	72	68	63	
		N°2	83	92	88	83	82	78	73	68	
	6 poles	6000 m ³ /h	N°1	61	75	73	66	66	72	64	57
			N°2	66	81	79	75	74	72	69	62
		4500 m ³ /h	N°1	58	73	72	64	65	66	62	56
			N°2	65	81	77	74	72	70	66	61
		3000 m ³ /h	N°1	72	79	75	66	65	63	59	54
			N°2	74	83	79	74	73	69	64	59
8 poles	4500 m ³ /h	N°1	55	69	67	60	60	66	58	51	
		N°2	60	75	73	69	68	66	63	56	
	3500 m ³ /h	N°1	52	67	65	58	59	60	55	50	
		N°2	59	75	71	68	66	64	60	55	
	2000 m ³ /h	N°1	66	73	69	60	59	57	53	48	
		N°2	68	77	73	68	67	63	58	53	

Poles	2	4	6	8	12
Fan speed (rpm)	3000	1500	1000	750	500

EXTRACTION ROOF FAN

TEDH F400 - TEDV F400

CENTRIFUGAL BACKWARD IMPELLER

Air performances

TEDH F400 560
TEDV F400 560

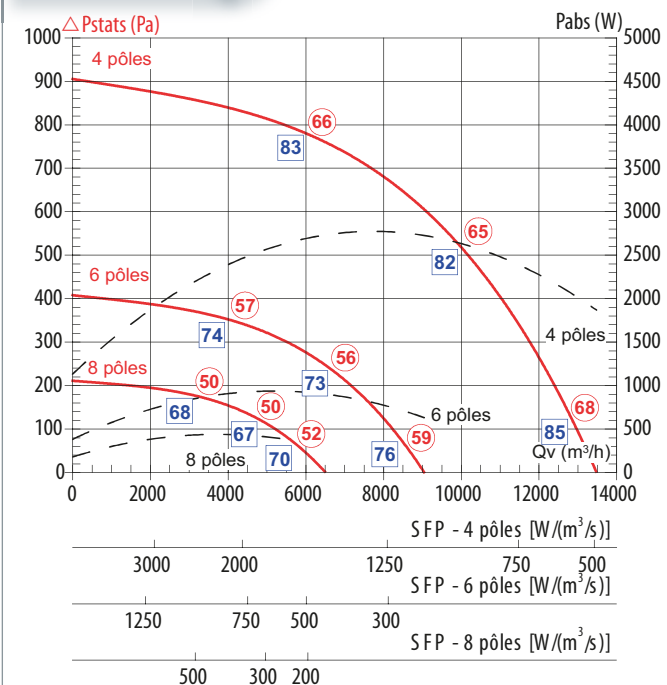

Frequency (Hz)		63	125	250	500	1K	2K	4K	8K	
4 poles	13000 m³/h	N°1	70	85	83	76	75	82	74	67
		N°2	76	93	90	87	85	82	83	73
	10000 m³/h	N°1	69	84	82	75	76	77	72	67
		N°2	72	90	87	84	83	80	77	72
	6000 m³/h	N°1	83	90	86	77	76	74	70	65
		N°2	83	93	91	85	84	80	75	71
6 poles	8500 m³/h	N°1	61	76	74	67	66	73	65	58
		N°2	67	84	81	78	76	73	74	64
	7000 m³/h	N°1	60	75	73	66	67	68	63	58
		N°2	63	81	78	75	74	71	68	63
	4000 m³/h	N°1	74	81	77	68	67	65	61	56
		N°2	74	84	82	76	75	71	66	62
8 poles	6000 m³/h	N°1	55	70	68	61	60	67	59	52
		N°2	60	78	75	72	70	67	68	57
	4500 m³/h	N°1	54	69	67	60	61	62	57	52
		N°2	57	75	72	69	68	65	62	57
	3000 m³/h	N°1	68	75	71	62	61	59	55	50
		N°2	68	78	76	70	69	65	60	55

○ : Lp dB (A) free field at 6 m
 □ : Lw dB (A) duct radiated
 N°1 : Lw dB duct radiated
 N°2 : Lw en dB free field

TEDH F400 630
TEDV F400 630

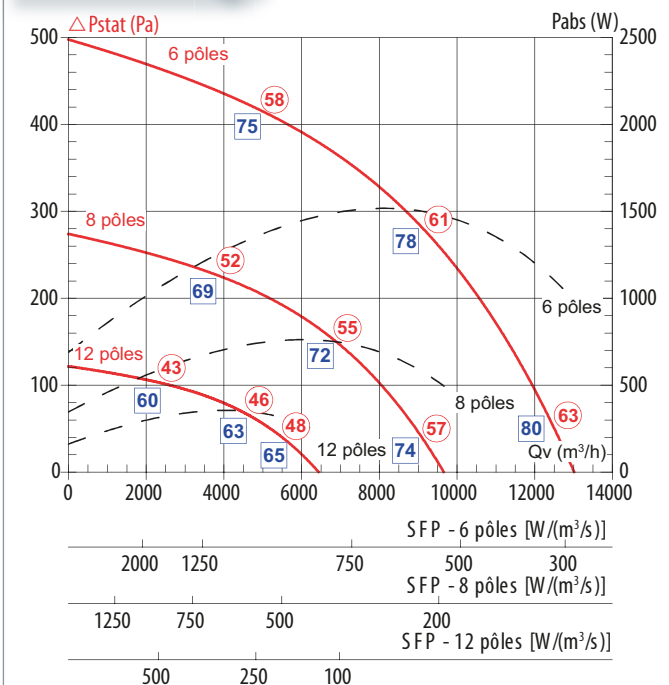

Frequency (Hz)		63	125	250	500	1K	2K	4K	8K	
6 Poles	13000 m³/h	N°1	65	79	77	70	70	76	68	61
		N°2	81	90	85	81	81	82	75	65
	9000 m³/h	N°1	64	79	78	70	71	72	68	62
		N°2	71	87	83	79	78	80	71	63
	5000 m³/h	N°1	75	82	78	69	68	66	62	57
		N°2	82	84	81	78	77	73	68	63
8 Poles	9000 m³/h	N°1	59	73	71	64	64	70	62	55
		N°2	75	84	79	75	75	76	69	59
	7000 m³/h	N°1	58	73	72	64	65	66	62	56
		N°2	65	81	77	73	72	74	65	57
	4000 m³/h	N°1	69	76	72	63	62	60	56	51
		N°2	76	79	76	72	71	68	62	57
12 Poles	6000 m³/h	N°1	50	64	62	55	55	61	53	46
		N°2	66	75	70	66	66	67	60	50
	4500 m³/h	N°1	49	64	63	55	56	57	53	47
		N°2	56	72	68	64	63	65	56	48
	2500 m³/h	N°1	60	67	63	54	53	51	47	42
		N°2	67	70	67	63	62	59	53	48

Smoke extraction fans

Poles	2	4	6	8	12
Fan speed (rpm)	3000	1500	1000	750	500

EXTRACTION ROOF FAN

TEDH F400 - TEDV F400

CENTRIFUGAL BACKWARD IMPELLER

Smoke extraction fans

Air performances

TEDH F400 695
TEDV F400 695

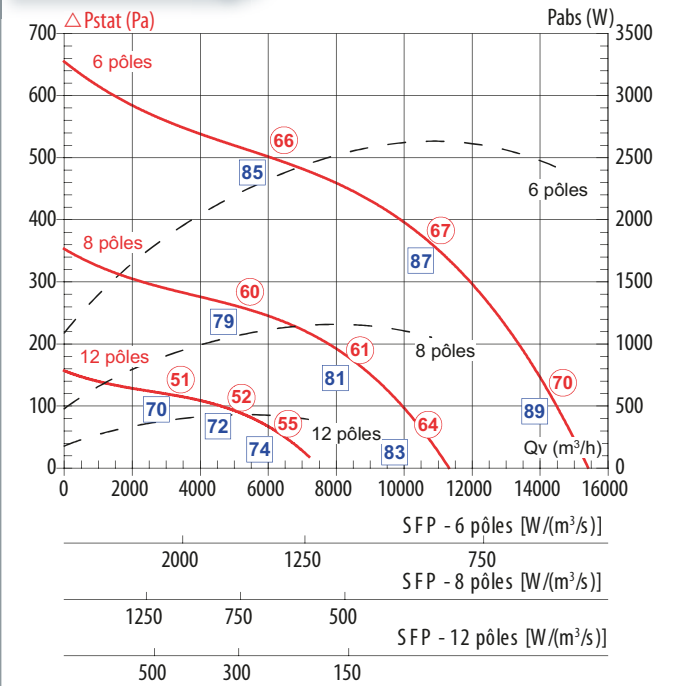

Frequency (Hz)		63	125	250	500	1K	2K	4K	8K		
6 poles	15000 m³/h	N°1	93	92	92	85	82	80	79	78	
		N°2	93	96	93	91	88	86	83	79	
	11000 m³/h	N°1	91	88	88	83	81	78	76	73	
		N°2	87	89	89	88	86	84	80	73	
	6000 m³/h	N°1	90	87	87	82	78	75	72	68	
		N°2	89	89	87	86	85	83	78	72	
	8 poles	10000 m³/h	N°1	87	86	86	79	76	74	73	72
			N°2	86	89	87	85	82	79	77	73
		8000 m³/h	N°1	85	82	82	77	75	72	70	67
			N°2	80	82	82	81	79	77	73	67
		5000 m³/h	N°1	84	81	81	76	72	69	66	62
			N°2	83	82	80	80	79	76	72	66
12 poles	6000 m³/h	N°1	78	77	77	70	67	65	64	63	
		N°2	78	81	78	76	73	71	68	64	
	5000 m³/h	N°1	76	73	73	68	66	63	61	58	
		N°2	72	74	74	73	71	69	65	58	
	3000 m³/h	N°1	75	72	72	67	63	60	57	53	
		N°2	74	74	72	71	70	68	63	57	

TEDH F400 710
TEDV F400 710

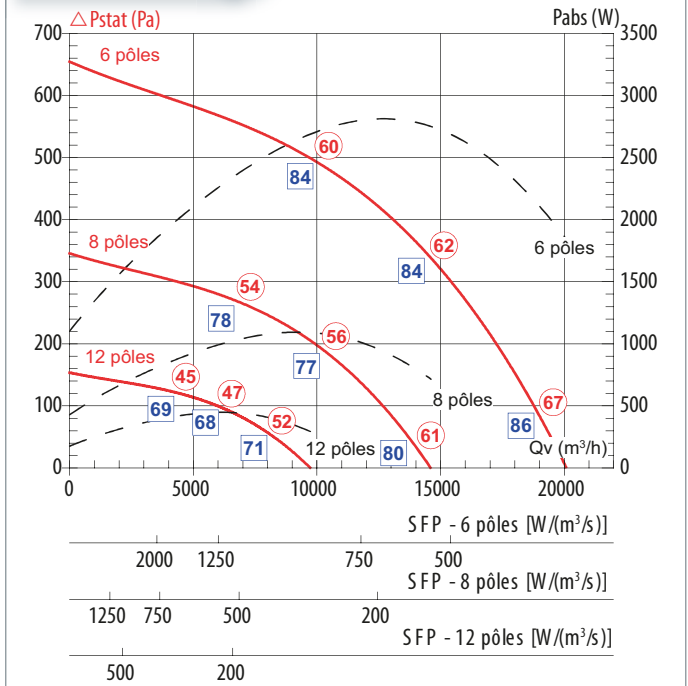

Frequency (Hz)		63	125	250	500	1K	2K	4K	8K		
6 poles	19000 m³/h	N°1	71	85	83	76	76	82	74	67	
		N°2	79	94	89	86	84	86	73	66	
	15000 m³/h	N°1	70	85	84	76	77	78	74	68	
		N°2	75	88	85	83	80	77	69	62	
	8000 m³/h	N°1	84	91	87	78	77	75	71	66	
		N°2	87	87	85	83	78	71	64	59	
	8 poles	14000 m³/h	N°1	65	79	77	70	70	76	68	61
			N°2	73	88	83	80	78	80	67	60
		10000 m³/h	N°1	63	78	77	69	70	71	67	61
			N°2	69	82	79	77	74	71	63	56
		7000 m³/h	N°1	78	85	81	72	71	69	65	60
			N°2	81	81	79	77	72	65	58	53
12 poles	8000 m³/h	N°1	56	70	68	61	61	67	59	52	
		N°2	64	79	74	71	69	71	58	51	
	6000 m³/h	N°1	54	69	68	60	61	62	58	52	
		N°2	60	73	70	68	65	62	54	47	
	4000 m³/h	N°1	69	76	72	63	62	60	56	51	
		N°2	72	72	70	68	63	56	49	44	

- : Lp dB (A) free field at 6 m
- : Lw dB (A) duct radiated
- N°1 : Lw dB duct radiated
- N°2 : Lw en dB free field

Poles	2	4	6	8	12
Fan speed (rpm)	3000	1500	1000	750	500

EXTRACTION ROOF FAN

TEDH F400 - TEDV F400

CENTRIFUGAL BACKWARD IMPELLER

Air performances

TEDH F400 760
TEDV F400 760

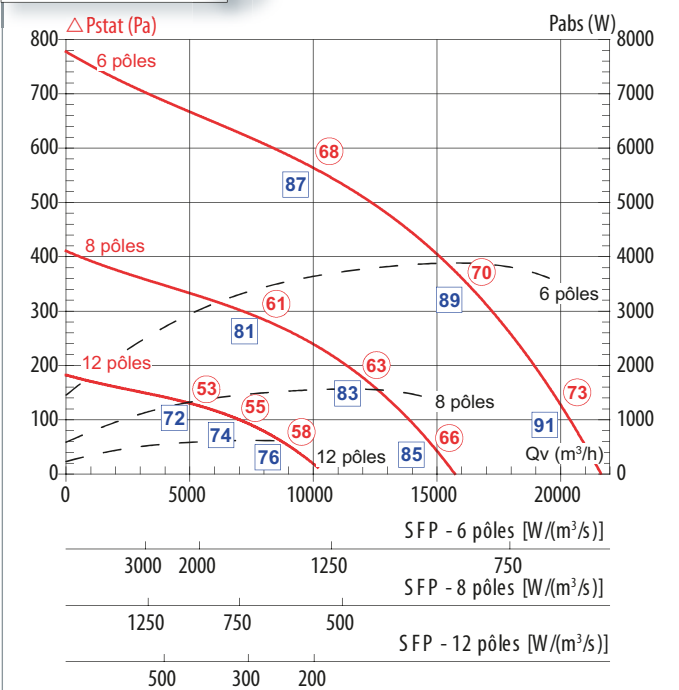

Frequency (Hz)		63	125	250	500	1K	2K	4K	8K		
6 poles	20000 m³/h	N°1	96	95	94	87	83	82	81	80	
		N°2	93	98	96	94	91	90	86	80	
	16000 m³/h	N°1	94	91	91	86	83	81	78	76	
		N°2	89	94	92	91	88	87	83	76	
	10000 m³/h	N°1	93	90	90	85	81	78	74	71	
		N°2	86	92	89	88	86	85	81	74	
	8 poles	14000 m³/h	N°1	90	89	88	81	77	76	75	74
			N°2	86	91	89	87	84	83	79	73
		11000 m³/h	N°1	88	85	85	80	77	75	72	70
			N°2	82	87	85	84	81	80	76	69
		8000 m³/h	N°1	87	84	84	79	75	72	68	65
			N°2	79	85	82	81	79	78	74	67
12 poles	9000 m³/h	N°1	81	80	79	72	68	67	66	65	
		N°2	78	83	81	79	76	75	71	65	
	7500 m³/h	N°1	79	76	76	71	68	66	63	61	
		N°2	74	79	77	76	73	72	68	61	
	5000 m³/h	N°1	78	75	75	70	66	63	59	56	
		N°2	71	77	74	73	71	70	66	59	

- : Lp dB (A) free field at 6 m
- : Lw dB (A) duct radiated
- N°1 : Lw dB duct radiated
- N°2 : Lw en dB free field

TEDH F400 810
TEDV F400 810

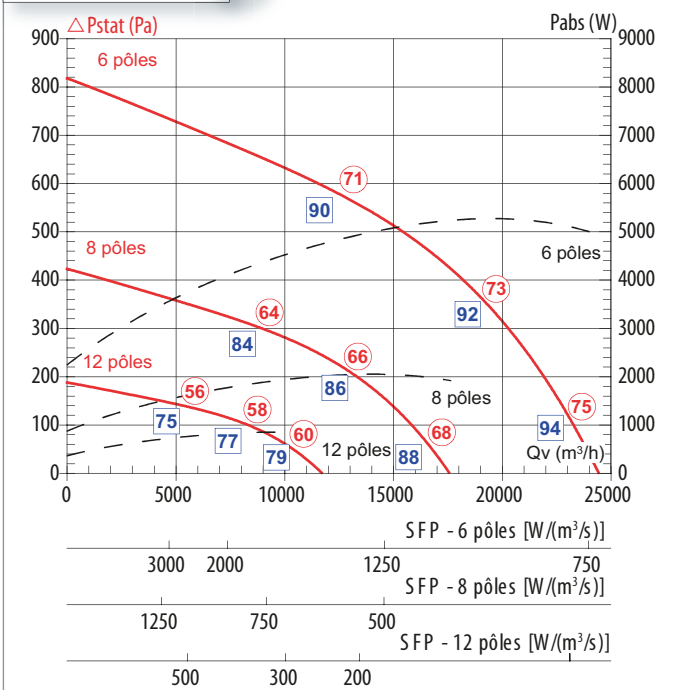

Frequency (Hz)		63	125	250	500	1K	2K	4K	8K		
6 poles	23000 m³/h	N°1	98	97	97	90	86	85	84	83	
		N°2	97	100	101	99	96	93	87	81	
	18000 m³/h	N°1	96	93	94	88	86	83	81	78	
		N°2	97	100	101	99	96	93	87	81	
	10000 m³/h	N°1	95	92	93	88	84	80	77	73	
		N°2	93	99	98	95	91	87	82	76	
	8 poles	16000 m³/h	N°1	92	91	91	84	80	79	78	77
			N°2	82	85	86	84	81	78	72	66
		12000 m³/h	N°1	90	87	88	82	80	77	75	72
			N°2	82	85	86	84	81	78	72	66
		9000 m³/h	N°1	89	86	87	82	78	74	71	67
			N°2	78	84	83	80	76	72	67	61
12 poles	10000 m³/h	N°1	83	82	82	75	71	70	69	68	
		N°2	97	100	101	99	96	93	87	81	
	8000 m³/h	N°1	81	78	79	73	71	68	66	63	
		N°2	97	100	101	99	96	93	87	81	
	6000 m³/h	N°1	80	77	78	73	69	65	62	58	
		N°2	93	99	98	95	91	87	82	76	

Smoke extraction fans

Poles	2	4	6	8	12
Fan speed (rpm)	3000	1500	1000	750	500

EXTRACTION ROOF FAN

TEDH F400 - TEDV F400

CENTRIFUGAL BACKWARD IMPELLER

Smoke extraction fans

Air performances

TEDH F400 800B
TEDV F400 800B

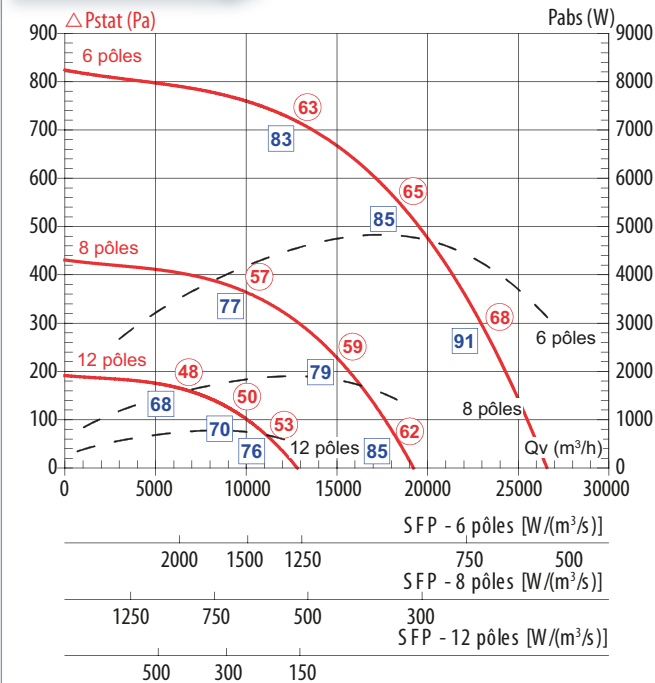

Frequency (Hz)		63	125	250	500	1K	2K	4K	8K		
6 poles	20000 m³/h	N°1	76	90	88	81	81	87	79	72	
		N°2	106	99	93	88	88	73	65	74	
	15000 m³/h	N°1	71	87	85	77	78	80	75	70	
		N°2	91	96	90	87	82	76	70	66	
	8000 m³/h	N°1	83	90	86	77	76	74	70	65	
		N°2	89	91	87	86	81	75	69	66	
	8 poles	17000 m³/h	N°1	70	84	82	75	75	81	73	66
			N°2	100	93	87	82	82	67	59	68
		12500 m³/h	N°1	65	81	79	71	72	74	69	64
			N°2	85	90	84	81	76	70	64	60
	7500 m³/h	N°1	77	84	80	71	70	68	64	59	
		N°2	83	85	81	80	75	69	63	60	
12 poles	10000 m³/h	N°1	61	75	73	66	66	72	64	57	
		N°2	91	84	78	73	73	58	50	59	
	7500 m³/h	N°1	56	72	70	62	63	65	60	55	
		N°2	76	81	75	72	67	61	55	51	
7500 m³/h	N°1	68	75	71	62	61	59	55	50		
	N°2	74	76	72	71	66	60	54	51		

- : Lp en dB (A) champ libre 6 m
- : Lw en dB (A) rayonné conduit
- N°1 : Lw en dB rayonné conduit
- N°2 : Lw en dB champ libre

TEDH F400 800H
TEDV F400 800H

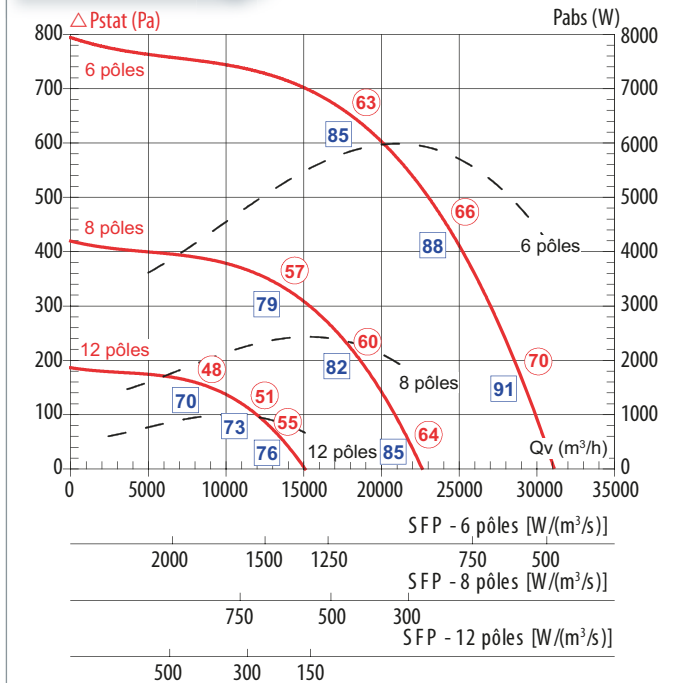

Frequency (Hz)		63	125	250	500	1K	2K	4K	8K		
6 poles	25000 m³/h	N°1	76	90	88	81	81	87	79	72	
		N°2	96	98	95	90	87	86	75	70	
	20000 m³/h	N°1	74	89	88	80	81	82	78	72	
		N°2	91	97	93	88	83	78	71	66	
	15000 m³/h	N°1	85	92	88	79	78	76	72	67	
		N°2	88	94	90	84	80	74	69	65	
	8 poles	20000 m³/h	N°1	70	84	82	75	75	81	73	66
			N°2	90	92	89	84	81	80	69	64
		15000 m³/h	N°1	68	83	82	74	75	76	72	66
			N°2	85	91	87	82	77	72	65	60
	11000 m³/h	N°1	79	86	82	73	72	70	66	61	
		N°2	82	88	84	78	74	68	63	59	
12 poles	12500 m³/h	N°1	61	75	73	66	66	72	64	57	
		N°2	81	83	80	75	72	71	60	55	
	10000 m³/h	N°1	59	74	73	65	66	67	63	57	
		N°2	76	82	78	73	68	63	56	51	
7000 m³/h	N°1	70	77	73	64	63	61	57	52		
	N°2	73	79	75	69	65	59	54	50		

Poles	2	4	6	8	12
Fan speed (rpm)	3000	1500	1000	750	500

EXTRACTION ROOF FAN

TEDH F400 - TEDV F400

CENTRIFUGAL BACKWARD IMPELLER

Air performances

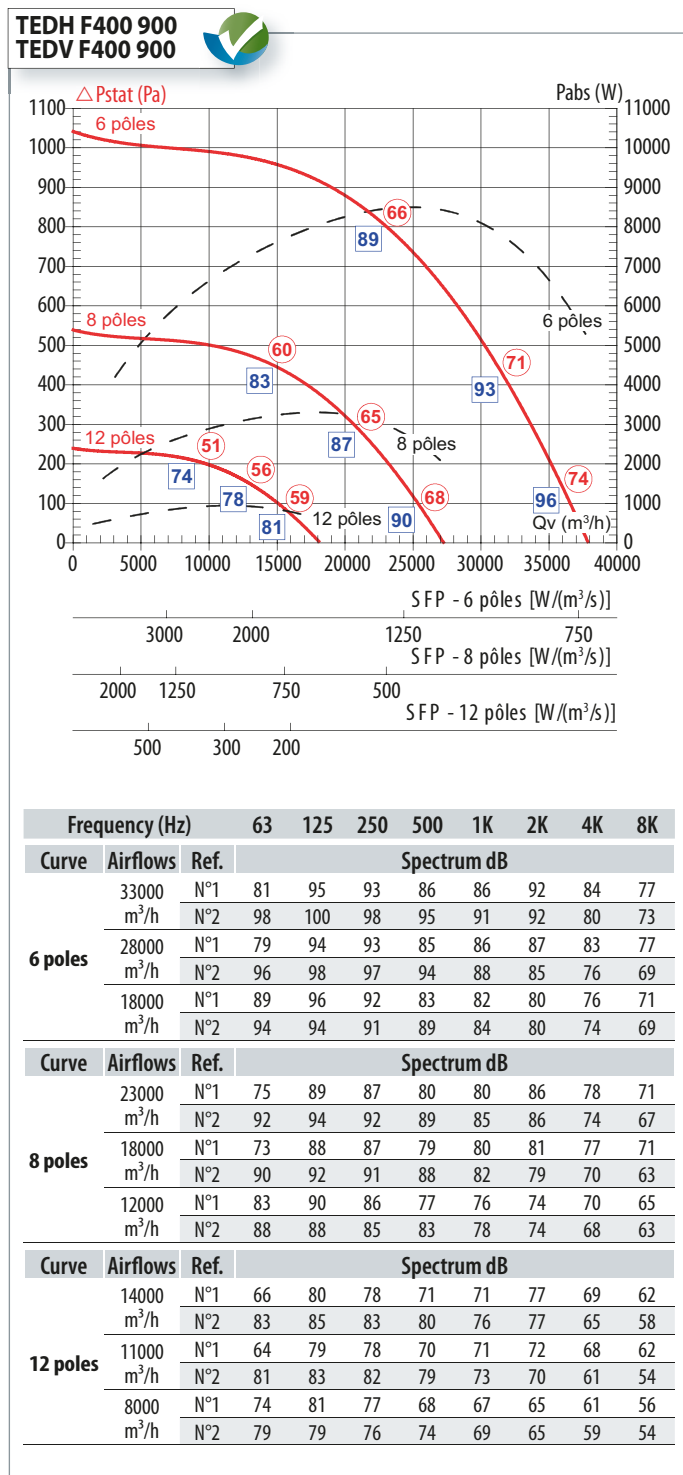

- : Lp en dB (A) champ libre 6 m
- : Lw en dB (A) rayonné conduit
- N°1 : Lw en dB rayonné conduit
- N°2 : Lw en dB champ libre

Poles	2	4	6	8	12
Fan speed (rpm)	3000	1500	1000	750	500

EXTRACTION ROOF FAN

TEDH F400 - TEDV F400

CENTRIFUGAL BACKWARD IMPELLER

Technical specifications

1 speed motor 1 phase

Size	Rated power P (kW)	Rated current I (A) 230V	Is / In	Starting time (s)	Weight (kg)	230V Control panel current
1 SPEED MOTOR 1 PHASE 2 POLES						
250	0,37	3	2	3	20	6
1 SPEED MOTOR 1 PHASE 4 POLES						
250	0,25	2,5	2,7	1	20	6
315	0,25	2,5	2,7	3	24	6
355	0,25	2,5	2,7	4	30	6
400	0,55	3,9	3,2	3	36	6
1 SPEED MOTOR 1 PHASE 6 POLES						
315	0,18	1,6	1,8	2	26	6
355	0,18	1,6	1,8	3	33	6
400	0,25	2,3	2	2	34	6
450	0,25	2,3	2	6	47	6
500	0,37	3	2	6	53	6

1 speed motor 3 phases

Size	Rated power P (kW)	Efficiency class	Rated current I (A) 230V	Rated current I (A) 400V	Is / In	Starting time (s)	Weight (kg)	230V Control panel current
1 SPEED MOTOR 3 PHASES 2 POLES								
250	0,37	IE1	1,62	0,93	4,3	2	20	6
250	0,37	IE2	1,56	0,89	5,8	2	22	6
1 SPEED MOTOR 3 PHASES 4 POLES								
250	0,25	IE1	1,4	0,81	3,5	1	20	6
250	0,25	IE2	1,36	0,78	4,5	1	22	6
315	0,25	IE1	1,4	0,81	3,5	2	24	6
315	0,25	IE2	1,36	0,78	4,5	2	26	6
355	0,25	IE1	1,4	0,81	3,5	3	31	6
355	0,25	IE2	1,36	0,78	4,5	3	33	6
400	0,55	IE1	2,47	1,42	4,7	3	36	6
400	0,55	IE2	2,28	1,31	6	2	39	6
400	0,55	IE3	2,17	1,25	6,6	2	39	6
450	1,1	IE2	4,33	2,49	6,5	3	59	6
450	1,1	IE3	4,07	2,34	7,6	2	59	6
500	1,5	IE2	5,67	3,26	6,3	3	65	6
500	1,5	IE3	5,48	3,15	7,4	3	65	6
560	2,2	IE2	8,29	4,8	7	3	87	6
560	2,2	IE3	7,93	4,56	7,4	3	87	6
1 SPEED MOTOR 3 PHASES 6 POLES								
315	0,18	IE1	1,28	0,74	3,3	1	25	6
315	0,18	IE2	1,26	0,72	3,2	2	27	6
355	0,18	IE1	1,28	0,74	3,3	2	32	6
355	0,18	IE2	1,26	0,72	3,2	2	34	6
400	0,37	IE1	1,97	1,13	3,6	2	36	6
400	0,37	IE2	1,83	1,05	3,9	2	39	6
450	0,37	IE1	1,97	1,13	3,6	4	49	6
450	0,37	IE2	1,83	1,05	3,9	4	52	6
500	0,55	IE1	2,82	1,62	4	5	55	6
500	0,55	IE2	2,59	1,49	4,1	4	56	6
560	0,75	IE2	3,39	1,95	4,5	5	76	6
630	1,1	IE2	4,83	2,78	4,7	5	88	6
695	2,2	IE2	10,3	5,94	7,1	3	106	6
695	2,2	IE3	9,08	5,22	6	3	106	6
710	3	IE2	12,7	7,3	5,7	6	158	10,6
710	3	IE3	12	6,91	6	6	158	10,6
760	3	IE2	12,7	7,3	5,7	4	125	10,6
760	3	IE3	12	6,91	6	4	125	10,6
800B	4	IE2	16,5	9,46	6	7	196	10,6
800B	4	IE3	15,6	8,99	6,5	7	196	10,6
800H	5,5	IE2	22,3	12,8	6,4	6	208	16,6
800H	5,5	IE3	21,7	12,5	7	5	208	16,6
810	5,5	IE2	22,3	12,8	6,4	2	147	16,6
810	5,5	IE3	21,7	12,5	7	2	147	16,6
900	7,5	IE3	25,6	14,7	6,5	6	331	16,6

Units are as standard set for smoke extraction.

EXTRACTION ROOF FAN

TEDH F400 - TEDV F400

CENTRIFUGAL BACKWARD IMPELLER

Technical specifications

1 speed motor 3 phases

Size	Rated power P (kW)	Efficiency class	Rated current I (A) 230V	Rated current I (A) 400V	Is / In	Starting time (s)	Weight (kg)	230V Control panel current
1 SPEED MOTOR 3 PHASES 8 POLES								
450	0,18	IE1	1,5	0,86	2,8	4	50	6
450	0,18	IE2	1,26	0,73	3,1	4	51	6
500	0,18	IE1	1,5	0,86	2,8	6	54	6
500	0,18	IE2	1,26	0,73	3,1	6	55	6
560	0,37	IE1	2,53	1,45	3	6	73	6
560	0,37	IE2	2,42	1,39	3,5	6	77	6
630	0,55	IE1	3,49	2,01	3,3	3	84	6
630	0,55	IE2	3,27	1,88	3,5	3	91	6
695	1,1	IE1	5,88	3,38	4	4	97	6
695	1,1	IE2	5,93	3,41	4,6	4	100	6
710	2,2	IE1	9,3	5,35	6,1	3	161	6
710	2,2	IE2	9,46	5,44	5,5	4	162	6
760	1,5	IE1	7,32	4,21	4,2	4	106	6
760	1,5	IE2	7,11	4,09	4,7	3	112	6
800B	2,2	IE1	9,3	5,35	6,1	6	185	6
800B	2,2	IE2	9,46	5,44	5,5	7	186	6
800H	2,2	IE1	9,3	5,35	6,1	6	193	6
800H	2,2	IE2	9,46	5,44	5,5	8	194	6
810	3	IE1	12,5	7,21	6,1	2	134	10,6
810	3	IE2	12,6	7,23	5,5	2	144	10,6
900	4	IE1	17,1	9,84	4,7	7	319	10,6
900	4	IE2	16,4	9,43	4,7	7	325	10,6

Units are as standard set for smoke extraction.

2 speeds motor 3 phases

Size	Rated power P GV/PV (kW)	Rated current I (A) GV 400V	Rated current I (A) PV 400V	Is / In GV/PV	Starting time (s)	Weight (kg)	230V Control panel current
2 SPEEDS MOTOR 3 PHASES - SEPARATE WINDINGS 4/6 POLES							
355	0,3/0,1	0,99	0,72	5/3,5	2/2	31	6
400	0,55/0,2	1,75	1,05	5/3,7	3/3	36	6
450	1,1/0,3	2,84	1,49	5,4/5,1	3/4	53	6
500	1,5/0,37	3,65	1,62	5,5/4,5	4/6	65	6
560	2,2/0,7	4,91	2,48	6/5,5	5/4	87	6
2 SPEEDS MOTOR 3 PHASES - SEPARATE WINDINGS 6/8 POLES							
450	0,37/0,2	1,4	0,99	3,6/3,3	5/5	52	6
500	0,55/0,37	1,89	1,79	3,8/3,3	6/7	68	6
560	0,75/0,37	2,42	1,44	4,1/3,2	6/6	82	6
630	1,1/0,55	3,54	2,63	5,8/5,1	6/4	95	6
695	3/0,75	8,04	3,78	6,6/5	3/3	133	10,6
710	3/0,75	8,04	3,78	6,6/5	5/7	176	10,6
760	4/1,1	16,2	4,45	6,5/5	2/3	152	16,6
800B	4/1,1	16,2	4,45	6,5/5	5/9	263	16,6
800H	5,5/2,75	11,9	8,68	6,5/6,2	6/5	272	16,6
810	5,5/2,75	11,9	8,68	6,5/6,2	6/5	211	16,6
2 SPEEDS MOTOR 3 PHASES - DAHLANDER WINDING 4/8 POLES							
355	0,6/0,15	1,82	0,81	5,5/3,1	1/1	33	6
400	0,6/0,15	1,82	0,81	5,5/3,1	2/2	34	6
450	1,2/0,3	2,92	1,29	5,5/3,1	3/3	53	6
500	1,6/0,4	3,85	1,45	5,7/3,2	3/3	66	6
560	2,2/0,55	4,84	2	6,9/3,5	3/3	85	6
2 SPEEDS MOTOR 3 PHASES - DAHLANDER WINDING 6/12 POLES							
630	1,1/0,22	4	1,36	6/2,4	5/2	99	6
695	4/1	12,6	5,13	6/2,5	2/2	196	16,6
710	4/1	12,6	5,13	6/2,5	3/4	172	16,6
760	4/1	12,6	5,13	6/2,5	2/3	131	16,6
800B	4/1	12,6	5,13	6/2,5	6/7	195	16,6
800H	5,5/1,1	12,8	7,2	6,1/3,6	6/8	272	16,6
810	5,5/1,1	12,8	7,2	6,1/3,6	3/3	211	16,6
900	7,5/2	16,3	7,16	6,4/3	6/6	355	16,6

Units are as standard set for smoke extraction.

EXTRACTION ROOF FAN

TEDH F400 - TEDV F400

CENTRIFUGAL BACKWARD IMPELLER

Non fitted accessories

Size	Motor power (kW)	Pole number	Supply	Energy eff.	DIJZ Circuit breaker		DEMZ 2S starter	1 Phase Comfort				3 Phases Comfort				
					230V	400V		Voltage variator		Frequency inverter		Frequency inverter				
							400V	VARZ	VAPZ	VEPZ	VRPZ	VFKB	VFTE	VFTM IP20	VFTM IP20	VFKB
250	0,37	2	1 ph.		003059			600056	600041	600044	600046					
	0,25	4	1 ph.		003059			600056	600041	600044	600046					
	0,37	2	3 ph.	IE1	003056	002787						256000	256091	256021	256030	256010
	0,25	4	3 ph.	IE1	003057	002787						256000	256091	256021	256030	256010
	0,37	2	3 ph.	IE2	003057	002787						256000	256091	256021	256030	256010
	0,25	4	3 ph.	IE2	003057	002787						256000	256090	256020	256030	256010
315	0,25	4	1 ph.		003059			600056	600041	600044	600046					
	0,18	6	1 ph.		003056			600055	600040	600044	600046					
	0,25	4	3 ph.	IE1	003057	002787						256000	256091	256021	256030	256010
	0,18	6	3 ph.	IE1	003057	002787						256000	256091	256020	256030	256010
	0,25	4	3 ph.	IE2	003057	002787						256000	256090	256020	256030	256010
	0,18	6	3 ph.	IE2	003057	002787						256000	256090	256020	256030	256010
355	0,25	4	1 ph.		003059			600056	600041	600044	600046					
	0,18	6	1 ph.		003056			600055	600040	600044	600046					
	0,25	4	3 ph.	IE1	003057	002787						256000	256091	256021	256030	256010
	0,18	6	3 ph.	IE1	003057	002787						256000	256091	256020	256030	256010
	0,25	4	3 ph.	IE2	003057	002787						256000	256090	256020	256030	256010
	0,18	6	3 ph.	IE2	003057	002787						256000	256090	256020	256030	256010
400	0,30/0,10	4/6	3 ph.				602525									
	0,60/0,15	4/8	3 ph.				602315									
	0,55	4	1 ph.		003059			600056	600041	600044	600046					
	0,25	6	1 ph.		003056			600055	600040	600044	600046					
	0,55	4	3 ph.	IE1	003059	003057						256001	256092	256021	256031	256010
	0,37	6	3 ph.	IE1	003056	003057						256000	256091	256021	256030	256010
450	0,55	4	3 ph.	IE2	003056	003057						256001	256092	256021	256030	256010
	0,37	6	3 ph.	IE2	003056	003057						256000	256091	256021	256030	256010
	0,55	4	3 ph.	IE3	003056	003057						256001	256092	256021	256030	256010
	0,55/0,20	4/6	3 ph.				602503									
	0,60/0,15	4/8	3 ph.				602315									
	0,25	6	1 ph.		003056			600055	600040	600044	600046					
500	0,37	6	3 ph.	IE1	003056	003057						256000	256091	256021	256030	256010
	0,18	8	3 ph.	IE1	003057	002787						256000	256091	256021	256030	256010
	1,1	4	3 ph.	IE2	003058	003059						256002	256094	256023	256033	256012
	0,37	6	3 ph.	IE2	003056	003057						256000	256091	256021	256030	256010
	0,18	8	3 ph.	IE2	003057	002787						256000	256090	256020	256030	256010
	1,1	4	3 ph.	IE3	003058	003056						256002	256094	256023	256033	256012
560	1,1/0,30	4/6	3 ph.				602515									
	1,2/0,30	4/8	3 ph.				602304									
	0,37	6	1 ph.		003059			600056	600041	600044	600046					
	0,55	6	3 ph.	IE1	003059	003056						256001	256092	256021	256031	256011
	0,18	8	3 ph.	IE1	003057	002787						256000	256091	256021	256030	256010
	1,5	4	3 ph.	IE2	003058	003059						256003	256094	256024	256034	256013
560	0,55	6	3 ph.	IE2	003059	003057						256001	256092	256021	256031	256010
	0,18	8	3 ph.	IE2	003057	002787						256000	256090	256020	256030	256010
	1,5	4	3 ph.	IE3	003058	003059						256003	256094	256024	256034	256013
	1,5/0,37	4/6	3 ph.				602511									
	1,6/0,40	4/8	3 ph.				602304									
	0,55/0,37	6/8	3 ph.				602500									
560	0,37	8	3 ph.	IE1	003059	003057						256001	256092	256021	256031	256010
	2,2	4	3 ph.	IE2	003060	003058						256001	256093	256022	256032	256011
	0,75	6	3 ph.	IE2	003059	003056						256001	256092	256021	256031	256010
	0,37	8	3 ph.	IE2	003056	003057						256001	256092	256021	256031	256010
	2,2	4	3 ph.	IE3	003060	003058						256001	256092	256021	256031	256010
	2,2/0,70	4/6	3 ph.				602505									
2,2/0,55	4/8	3 ph.				602313										
0,75/0,37	6/8	3 ph.				602515										

Smoke extraction fans

EXTRACTION ROOF FAN

TEDH F400 - TEDV F400

CENTRIFUGAL BACKWARD IMPELLER

Non fitted accessories

Size	Motor power (kW)	Pole number	Supply	Energy eff.	DIJZ Circuit breaker		DEMZ 2S starter	1 Phase Comfort						3 Phases Comfort		
					230V	400V		Voltage variator				Frequency inverter		Frequency inverter		
							400V	VARZ	VAPZ	VEPZ	VRPZ	VFKB	VFTE	VFTM IP20	VFTM IP20	VFKB
630	0,55	8	3 ph.	IE1	003059	003056						256001	256093	256023	256032	256012
	1,1	6	3 ph.	IE2	003058	003059						256003	256094	256024	256033	256013
	0,55	8	3 ph.	IE2	003059	003056						256001	256093	256022	256032	256011
	1,1/0,55	6/8	3 ph.				602504									
	1,1/0,22	6/12	3 ph.				602304									
695	1,1	8	3 ph.	IE1	003058	003059						256003	256094	256024	256034	256014
	2,2	6	3 ph.	IE2	003061	003058							256026	256036	256015	
	1,1	8	3 ph.	IE2	003058	003059						256003	256094	256024	256034	256014
	2,2	6	3 ph.	IE3	003060	003058							256026	256036	256015	
	3/0,75	6/8	3 ph.											256026	256036	256015
710	4/1	6/12	3 ph.													
	2,2	8	3 ph.	IE1										256026	256036	256015
	3	6	3 ph.	IE2											256037	256016
	2,2	8	3 ph.	IE2										256026	256036	256015
	3	6	3 ph.	IE3											256037	256016
760	3/0,75	6/8	3 ph.													
	4/1	6/12	3 ph.													
	1,5	8	3 ph.	IE1	003060	003058							256095	256025	256035	256014
	3	6	3 ph.	IE2	003061	003060									256037	256016
	1,5	8	3 ph.	IE2	003060	003058							256095	256025	256035	256014
800B	3	6	3 ph.	IE3	003061	003060									256037	256016
	4/1,1	6/8	3 ph.				602510									
	4/1	6/12	3 ph.				602312									
	2,2	8	3 ph.	IE1										256026	256036	256015
	4	6	3 ph.	IE2											256038	
800H	2,2	8	3 ph.	IE2										256026	256036	256015
	4	6	3 ph.	IE2											256038	
	2,2	8	3 ph.	IE2										256026	256036	256015
	5,5	6	3 ph.	IE3											256038	
	5,5/2,75	6/8	3 ph.													
810	5,5/1,1	6/12	3 ph.													
	3	8	3 ph.	IE1	003061	003060									256037	256016
	5,5	6	3 ph.	IE2	003990	003061									256038	
	3	8	3 ph.	IE2	003061	003060									256037	256016
	5,5	6	3 ph.	IE3	003990	003061									256038	
900	5,5/2,75	6/8	3 ph.				602526									
	5,5/1,1	6/12	3 ph.				602319									
	4	8	3 ph.	IE1											256038	
	7,5	6	3 ph.	IE2											256039	
	4	8	3 ph.	IE2											256038	
900	7,5	6	3 ph.	IE3											256039	
	7,5/2	6/12	3 ph.													

EXTRACTION ROOF FAN

TEDH F400 - TEDV F400

CENTRIFUGAL BACKWARD IMPELLER

Fitted and wired accessories

Size	Motor power (kW)	Pole number	Supply	Energy eff.	Frequency inverter 1 ph.				Frequency inverter 3 ph.			
					VFTM IP55 Comfort	VFTM PR IP55 Comfort	VFTM IP55 smoke extract.	VFTM PR IP55 smoke extract.	VFTM IP55 Comfort	VFTM PR IP55 Comfort	VFTM IP55 smoke extract.	VFTM PR IP55 smoke extract.
250	0,37	2	1 ph.	IE1								
	0,25	4	1 ph.	IE1								
	0,37	2	3 ph.	IE1	156140	600530	156140	600530	256071	600536	256072	600537
	0,25	4	3 ph.	IE1	156140	600530	156140	600530	256071	600536	256071	600536
	0,37	2	3 ph.	IE2	156140	600530	156140	600530	256071	600536	256071	600536
315	0,25	4	3 ph.	IE2	156145	600529	156140	600530	256071	600536	256071	600536
	0,18	6	1 ph.	IE1								
	0,25	4	3 ph.	IE1	156140	600530	156140	600530	256071	600536	256071	600536
	0,18	6	3 ph.	IE1	156145	600529	156140	600530	256071	600536	256071	600536
	0,25	4	3 ph.	IE2	156145	600529	156140	600530	256071	600536	256071	600536
355	0,18	6	3 ph.	IE2	156145	600529	156140	600530	256071	600536	256071	600536
	0,25	4	1 ph.	IE1								
	0,18	6	1 ph.	IE1								
	0,25	4	3 ph.	IE1	156140	600530	156140	600530	256071	600536	256071	600536
	0,18	6	3 ph.	IE1	156145	600529	156140	600530	256071	600536	256071	600536
400	0,25	4	3 ph.	IE2	156145	600529	156140	600530	256071	600536	256071	600536
	0,18	6	3 ph.	IE2	156145	600529	156140	600530	256071	600536	256071	600536
	0,30/0,10	4/6	3 ph.	IE1								
	0,60/0,15	4/8	3 ph.	IE1								
	0,55	4	1 ph.	IE1								
450	0,25	6	1 ph.	IE1								
	0,55	4	3 ph.	IE1	156140	600530	156142	600532	256072	600537	256073	600538
	0,37	6	3 ph.	IE1	156140	600530	156140	600530	256071	600536	256072	600537
	0,55	4	3 ph.	IE2	156140	600530	156141	600530	256071	600536	256073	600538
	0,37	6	3 ph.	IE2	156140	600530	156140	600530	256071	600536	256072	600537
	0,55	4	3 ph.	IE3	156140	600530	156141	600530	256071	600536	256073	600538
	0,55/0,20	4/6	3 ph.	IE1								
	0,60/0,15	4/8	3 ph.	IE1								
	0,25	6	1 ph.	IE1								
500	0,37	6	3 ph.	IE1	156140	600530	156140	600530	256071	600536	256072	600537
	0,18	8	3 ph.	IE1	156140	600530	156140	600530	256071	600536	256071	600536
	1,1	4	3 ph.	IE2	156142	600532	156143	600533	256074	600539	256075	600540
	0,37	6	3 ph.	IE2	156140	600530	156140	600530	256071	600536	256072	600537
	0,18	8	3 ph.	IE2	156145	600529	156140	600530	256071	600536	256071	600536
	1,1	4	3 ph.	IE3	156142	600530	156143	600533	256074	600539	256075	600540
	1,1/0,30	4/6	3 ph.	IE1								
	1,2/0,30	4/8	3 ph.	IE1								
	0,37/0,20	6/8	3 ph.	IE1								
560	0,37	6	1 ph.	IE1								
	0,55	6	3 ph.	IE1	156140	600530	156142	600532	256072	600537	256074	600539
	0,18	8	3 ph.	IE1	156140	600530	156140	600530	256071	600536	256071	600536
	1,5	4	3 ph.	IE2	156143	600533	256070	600535	256075	600540	256076	600541
	0,55	6	3 ph.	IE2	156140	600530	156142	600532	256072	600537	256074	600539
	0,18	8	3 ph.	IE2	156145	600529	156140	600530	256071	600536	256071	600536
	1,5	4	3 ph.	IE3	156143	600533	256070	600535	256075	600540	256076	600541
	1,5/0,37	4/6	3 ph.	IE1								
	1,6/0,40	4/8	3 ph.	IE1								
600	0,55/0,37	6/8	3 ph.	IE1								
	0,37	8	3 ph.	IE1	156140	600530	156142	600532	256072	600537	256074	600539
	2,2	4	3 ph.	IE2	256070	600535			256076	600541	256078	600543
	0,75	6	3 ph.	IE2	156141	600531	156143	600533	256073	600538	256075	600540
	0,37	8	3 ph.	IE2	156140	600530	156142	600532	256072	600537	256073	600538
	2,2	4	3 ph.	IE3	256070	600535			256076	600541	256078	600543
	2,2/0,70	4/6	3 ph.	IE1								
	2,2/0,55	4/8	3 ph.	IE1								
	0,75/0,37	6/8	3 ph.	IE1								

Smoke extraction fans

EXTRACTION ROOF FAN

TEDH F400 - TEDV F400

CENTRIFUGAL BACKWARD IMPELLER

Fitted and wired accessories

Size	Motor power (kW)	Pole number	Supply	Energy eff.	Frequency inverter 1 ph.				Frequency inverter 3 ph.			
					VFTM IP55 Comfort	VFTM PR IP55 Comfort	VFTM IP55 smoke extract.	VFTM PR IP55 smoke extract.	VFTM IP55 Comfort	VFTM PR IP55 Comfort	VFTM IP55 smoke extract.	VFTM PR IP55 smoke extract.
630	0,55	8	3 ph.	IE1	156142	600532	156143	600533	256073	600538	256075	600540
	1,1	6	3 ph.	IE2	156143	600533	156144	600534	256074	600539	256076	600541
	0,55	8	3 ph.	IE2	156141	600531	156143	600533	256073	600538	256074	600539
	1,1/0,55	6/8	3 ph.	IE1								
	1,1/0,22	6/12	3 ph.	IE1								
695	1,1	8	3 ph.	IE1	156143	600533	256070	600535	256075	600540	256076	600541
	2,2	6	3 ph.	IE2	256070	600535			256077	600542	256078	600543
	1,1	8	3 ph.	IE2	156143	600533	256070	600535	256075	600540	256077	600542
	2,2	6	3 ph.	IE3	256070	600535			256077	600542	256078	600543
	3/0,75	6/8	3 ph.	IE1								
710	4/1	6/12	3 ph.	IE1								
	2,2	8	3 ph.	IE1	256070	600535			256077	600542	256078	600543
	3	6	3 ph.	IE2					256078	600543	256079	
	2,2	8	3 ph.	IE2	256070	600535			256077	600542	256078	600543
	3	6	3 ph.	IE3					256078	600543	256079	
760	3/0,75	6/8	3 ph.	IE1								
	4/1	6/12	3 ph.	IE1								
	1,5	8	3 ph.	IE1	156144	600534			256076	600541	256077	600542
	3	6	3 ph.	IE2					256078	600543	256079	
	1,5	8	3 ph.	IE2	156144	600534	256070	600535	256076	600541	256077	600542
800B	3	6	3 ph.	IE3					256078	600543	256079	
	4/1,1	6/8	3 ph.	IE1								
	4/1	6/12	3 ph.	IE1								
	2,2	8	3 ph.	IE1	256070	600535			256077	600542	256078	600543
	4	6	3 ph.	IE2					256079		256080	
800H	2,2	8	3 ph.	IE2	256070	600535			256077	600542	256078	600543
	5,5	6	3 ph.	IE3					256079		256081	
	2,2	8	3 ph.	IE2	256070	600535			256077	600542	256078	600543
	5,5	6	3 ph.	IE3					256079		256081	
	5,5/2,75	6/8	3 ph.	IE1								
810	5,5/1,1	6/12	3 ph.	IE1								
	3	8	3 ph.	IE1					256078	600543	256079	
	5,5	6	3 ph.	IE2					256079		256081	
	3	8	3 ph.	IE2					256078	600543	256079	
	5,5/2,75	6/8	3 ph.	IE1								
900	5,5/1,1	6/12	3 ph.	IE1								
	4	8	3 ph.	IE1					256079		256080	
	7,5	6	3 ph.	IE2					256080			
	4	8	3 ph.	IE2					256079		256080	
	7,5	6	3 ph.	IE3					256080			
7,5/2	6/12	3 ph.	IE1									

EXTRACTION ROOF FAN

TEDH F400 - TEDV F400

CENTRIFUGAL BACKWARD IMPELLER

Control panels

Size	Motor power (kW)	Pole number	Supply	Energy eff.	1 phase			3 phases							
					DP1M	D1C1M	D1C1MT	DP1X	DP1V	D1C1VT	DP2I	D1C2I	D1C2IT	D2C2IT	
250	0,37	2	1 ph.	IE1	520302	521302	521352								
	0,25	4	1 ph.	IE1	520302	521302	521352								
	0,37	2	3 ph.	IE1				520402	520002	522002			521002		
	0,25	4	3 ph.	IE1				520402	520002	522002			521002		
	0,37	2	3 ph.	IE2				520402	520002	522002			521002		
	0,25	4	3 ph.	IE2				520402	520002	522002			521002		
315	0,25	4	1 ph.	IE1	520302	521302	521352								
	0,18	6	1 ph.	IE1	520302	521302	521332								
	0,25	4	3 ph.	IE1				520402	520002	522002			521002		
	0,18	6	3 ph.	IE1				520402	520002	522002			521002		
	0,25	4	3 ph.	IE2				520402	520002	522002			521002		
	0,18	6	3 ph.	IE2				520402	520002	522002			521002		
355	0,25	4	1 ph.	IE1	520302	521302	521352								
	0,18	6	1 ph.	IE1	520302	521302	521332								
	0,25	4	3 ph.	IE1				520402	520002	522002			521002		
	0,18	6	3 ph.	IE1				520402	520002	522002			521002		
	0,25	4	3 ph.	IE2				520402	520002	522002			521002		
	0,18	6	3 ph.	IE2				520402	520002	522002			521002		
0,30/0,10	4/6	3 ph.	IE1								520102	521002	522272	523792	
400	0,55	4	1 ph.	IE1	520302	521302	521362								
	0,25	6	1 ph.	IE1	520302	521302	521352								
	0,55	4	3 ph.	IE1				520402	520002	522012			521002		
	0,37	6	3 ph.	IE1				520402	520002	522002			521002		
	0,55	4	3 ph.	IE2				520402	520002	522002			521002		
	0,37	6	3 ph.	IE2				520402	520002	522002			521002		
	0,55	4	3 ph.	IE3				520402	520002	522002			521002		
	0,55/0,20	4/6	3 ph.	IE1								520102	521002	522372	523892
450	0,25	6	1 ph.	IE1	520302	521302	521352								
	0,37	6	3 ph.	IE1				520402	520002	522002			521002		
	0,18	8	3 ph.	IE1				520402	520002	522002			521002		
	1,1	4	3 ph.	IE2				520402	520002	522032			521002		
	0,37	6	3 ph.	IE2				520402	520002	522002			521002		
	0,18	8	3 ph.	IE2				520402	520002	522002			521002		
	1,1	4	3 ph.	IE3				520402	520002	522032			521002		
	1,1/0,30	4/6	3 ph.	IE1								520102	521002	522422	523942
	0,37/0,20	6/8	3 ph.	IE1								520102	521002	522332	523852
	500	0,37	6	1 ph.	IE1	520302	521302	521352							
0,55		6	3 ph.	IE1				520402	520002	522012			521002		
0,18		8	3 ph.	IE1				520402	520002	522002			521002		
1,5		4	3 ph.	IE2				520402	520002	522042			521002		
0,55		6	3 ph.	IE2				520402	520002	522012			521002		
0,18		8	3 ph.	IE2				520402	520002	522002			521002		
1,5		4	3 ph.	IE3				520402	520002	522042			521002		
1,5/0,37		4/6	3 ph.	IE1								520102	521002	522462	523982
0,55/0,37		6/8	3 ph.	IE1								520102	521002	522372	523892
560		0,37	8	3 ph.	IE1				520402	520002	522012			521002	
	2,2	4	3 ph.	IE2				520412	520002	522052			521002		
	0,75	6	3 ph.	IE2				520402	520002	522022			521002		
	0,37	8	3 ph.	IE2				520402	520002	522012			521002		
	2,2	4	3 ph.	IE3				520412	520002	522052			521002		
	2,2/0,70	4/6	3 ph.	IE1								520102	521002	522522	524042
	0,75/0,37	6/8	3 ph.	IE1								520102	521002	522422	523942
630	0,55	8	3 ph.	IE1				520402	520002	522022			521002		
	1,1	6	3 ph.	IE2				520402	520002	522032			521002		
	0,55	8	3 ph.	IE2				520402	520002	522022			521002		
	1,1/0,55	6/8	3 ph.	IE1								520102	521002	522482	524002

Red code : can be fitted and wired,
Black code : provided as accessory, or wired (code 235740 1 speed, code 235760 2 speeds).

EXTRACTION ROOF FAN

TEDH F400 - TEDV F400

CENTRIFUGAL BACKWARD IMPELLER

Control panels

Size	Motor power (kW)	Pole number	Supply	Energy eff.	1 phase			3 phases						
					DP1M	D1C1M	D1C1MT	DP1X	DP1V	D1C1VT	DP2I	D1C2I	D1C2IT	D2C2IT
695	1,1	8	3 ph.	IE1				520402	520002	522042		521002		
	1,1	8	3 ph.	IE2				520402	520002	522042		521002		
	2,2	6	3 ph.	IE2				520412	520002	522052		521002		
	2,2	6	3 ph.	IE3				520412	520002	522052		521002		
	3/0,75	6/8	3 ph.	IE1							520112	521012	522652	524172
710	2,2	8	3 ph.	IE1				520412	520002	522052		521002		
	3	6	3 ph.	IE2				520412	520012	522072		521012		
	2,2	8	3 ph.	IE2				520412	520002	522052		521002		
	3	6	3 ph.	IE3				520412	520012	522072		521012		
	3/0,75	6/8	3 ph.	IE1							520112	521012	522652	524172
760	1,5	8	3 ph.	IE1				520412	520002	522052		521002		
	3	6	3 ph.	IE2				520412	520012	522072		521012		
	1,5	8	3 ph.	IE2				520412	520002	522042		521002		
	3	6	3 ph.	IE3				520412	520012	522072		521012		
	4/1,1	6/8	3 ph.	IE1							520122	521122	522752	524272
800B	2,2	8	3 ph.	IE1				520412	520002	522052		521002		
	4	6	3 ph.	IE2				520422	520012	522082		521012		
	2,2	8	3 ph.	IE2				520412	520002	522052		521002		
	4	6	3 ph.	IE3				520422	520012	522082		521012		
	4/1,1	6/8	3 ph.	IE1							520122	521022	522752	524272
800H	2,2	8	3 ph.	IE1				520412	520002	522052		521002		
	5,5	6	3 ph.	IE2				520432	520022	522102		520022		
	2,2	8	3 ph.	IE2				520412	520002	522052		521002		
	5,5	6	3 ph.	IE3				520432	520022	522102		520022		
	5,5/2,75	6/8	3 ph.	IE1							520122	521022	522772	524292
810	3	8	3 ph.	IE1				520422	520012	522072		521012		
	5,5	6	3 ph.	IE2				520432	520022	522102		521022		
	3	8	3 ph.	IE2				520422	520012	522072		521012		
	5,5	6	3 ph.	IE3				520432	520022	522102		521022		
	5,5/2,75	6/8	3 ph.	IE1							520122	521022	522772	524292
900	4	8	3 ph.	IE1				520432	520012	522082		521012		
	4	8	3 ph.	IE2				520422	520012	522082		521012		
	7,5	6	3 ph.	IE3				520432	520022	522112		521022		

Red code : can be fitted and wired,

Black code : provided as accessory, or wired (code 235740 1 speed, code 235760 2 speeds).

PILOTAIR® designation	Supply	Smoke extr. speed	Comfort speed	Therm. protec.	Progr. start	Type
DP1M	1 ph.	1		no		1 phase 1 speed smoke extract.
D1C1M	1 ph.	1	1	no		1 phase 1 speed smoke extract. 1 speed comfort
D1C1MT	1 ph.	1	1	yes		1 phase 1 speed smoke extract. 1 speed comfort and thermal prot.
DP1X	3 ph. 230	1		no		3 phases 230V 1 speed smoke extract.
DP1V	3 ph. 400	1		no		3 phases 400V 1 speed smoke extract.
D1C1VT	3 ph. 400	1	1	yes		3 phases 400V 1 speed smoke extract. 1 speed comfort and thermal prot.
DP2I	3 ph. 400	2		no		3 phases 400V 2 speeds smoke extract., separate windings.
D1C2I	3 ph. 400	1	2	no		3 phases 400V 1 speed smoke extract. 2 speeds comfort, separate windings.
D1C2IT	3 ph. 400 BI	1	2	yes		3 phases 400V 1 speed smoke extract. 2 speeds comfort, separate windings and thermal prot.
D2C2IT	3 ph. 400 BI	2	2	yes		3 phases 400V 2 speeds smoke extract. 2 speeds comfort, separate windings and thermal prot.
DP2D	3 ph. 400	2		no		3 phases 400V 2 speeds smoke extract., Dahlander windings.
D1C2D	3 ph. 400 BD	1	2	no		3 phases 400V 1 speed smoke extract. 2 speeds comfort, Dahlander windings.
D1C2DT	3 ph. 400 BD	1	2	yes		3 phases 400V 1 speed smoke extract. 2 speeds comfort, Dahlander windings and thermal prot.
D2C2DT	3 ph. 400	2	2	yes		3 phases 400V 2 speeds smoke extract. 2 speeds comfort, Dahlander windings and thermal prot.
IDC DP1V	3 ph. 400	1		no	yes	3 phases 400V 1 speed smoke extract. and progressive start.
IDC D1C1V	3 ph. 400	1	1	no	yes	3 phases 400V 1 speed smoke extract. 1 speed comfort and progressive start.
IDC D1C1VT	3 ph. 400	1	1	yes	yes	3 phases 400V 1 speed smoke extract. 1 speed comfort, thermal prot. and progressive start.
IDC DP2I	3 ph. 400	2		no	yes	3 phases 400V 2 speeds smoke extract., separate windings and progressive start.
IDC D1C2I	3 ph. 400	1	2	no	yes	3 phases 400V 1 speed smoke extract. 2 speeds comfort, separate windings and progressive start.
IDC D1C2IT	3 ph. 400	1	2	yes	yes	3 phases 400V 1 speed smoke extract. 2 speeds comfort, separate windings, thermal prot. and progressive start.
IDC D2C2IT	3 ph. 400	2	2	yes	yes	3 phases 400V 2 speeds smoke extract. 2 speeds comfort, Dahlander windings, thermal prot. and progressive start.

EXTRACTION ROOF FAN

TEDH F400 - TEDV F400

CENTRIFUGAL BACKWARD IMPELLER

Control panels

Size	Motor power (kW)	Pole number	Supply	Energy eff.	3 phases											
					DP2D	D1C2D	D1C2DT	D2C2DT	IDC DP1V	IDC D1C1V	IDC D1C1VT	IDC DP2I	IDC D1C2I	IDC D1C2IT	IDC D2C2IT	
355	0,60/0,15	4/8	3 ph.	IE1	520202	521202	525412	526682								
400	0,60/0,15	4/8	3 ph.	IE1	520202	521202	525412	526682								
450	1,2/0,30	4/8	3 ph.	IE1	520202	521202	525462	526732								
500	1,6/0,40	4/8	3 ph.	IE1	520202	521202	525522	526792								
	2,2	4	3 ph.	IE2					520502	521502	527822					
	2,2	4	3 ph.	IE3					520502	521502	527822					
560	2,2/0,70	4/6	3 ph.	IE1								520602	521602	528022	529192	
	2,2/0,55	4/8	3 ph.	IE1	520202	521202	525562	525562								
630	1,1/0,22	6/12	3 ph.	IE1	520202	521202	525552	526822								
	2,2	6	3 ph.	IE2					520502	521502	527822					
695	3/0,75	6/8	3 ph.	IE1								520602	521602	528102	529272	
	4/1	6/12	3 ph.	IE1	520222	521222	525792	527062								
710	2,2	8	3 ph.	IE1					520502	521502	527822					
	3	6	3 ph.	IE2					520502	521502	527832					
	2,2	8	3 ph.	IE2					520502	521502	527822					
	3	6	3 ph.	IE3					520502	521502	527832					
	3/0,75	6/8	3 ph.	IE1								520602	521602	528102	529272	
760	4/1	6/12	3 ph.	IE1	520222	521222	525792	527062								
	3	6	3 ph.	IE2					520502	521502	527832					
	3	6	3 ph.	IE3					520502	521502	527832					
	4/1,1	6/8	3 ph.	IE1								520602	521602	528152	529322	
	4/1	6/12	3 ph.	IE1	520222	521222	525792	527062								
800B	2,2	8	3 ph.	IE1					520502	521502	527822					
	4	6	3 ph.	IE2					520502	521502	527842					
	2,2	8	3 ph.	IE2					520502	521502	527822					
	4	6	3 ph.	IE3					520502	521502	527842					
	4/1,1	6/8	3 ph.	IE1								520602	521602	528152	529322	
800H	4/1	6/12	3 ph.	IE1	520222	521222	525792	527062								
	2,2	8	3 ph.	IE1					520502	521502	527822					
	5,5	6	3 ph.	IE2					520502	521502	527852					
	2,2	8	3 ph.	IE2					520502	521502	527822					
	5,5	6	3 ph.	IE3					520502	521502	527852					
	5,5/2,75	6/8	3 ph.	IE1								520602	521602	528172	529342	
810	5,5/1,1	6/12	3 ph.	IE1	520222	521222	525842	527112								
	3	8	3 ph.	IE1					520502	521502	527832					
	5,5	6	3 ph.	IE2					520502	521502	527852					
	3	8	3 ph.	IE2					520502	521502	527832					
	5,5	6	3 ph.	IE3					520502	521502	527852					
	5,5/2,75	6/8	3 ph.	IE1								520602	521602	528172	529342	
900	5,5/1,1	6/12	3 ph.	IE1	520222	521222	525842	527112								
	4	8	3 ph.	IE1					520502	521502	527842					
	4	8	3 ph.	IE2					520502	521502	527842					
	7,5	6	3 ph.	IE3					520502	521502	527862					
	7,5/2	6/12	3 ph.	IE1	520232	521232	525932	527202								

Red code : can be fitted and wired,

Black code : provided as accessory, or wired (code 235740 1 speed, code 235760 2 speeds).

EXTRACTION ROOF FAN

TEDH F400 - TEDV F400

CENTRIFUGAL BACKWARD IMPELLER

Control panels

PILOTAIR® designation	Supply	Smoke extr. speed	Comfort speed	Therm. protec.	Progr. start	Type
DP1M	Mono	1		no		1 phase 1 speed smoke extract.
D1C1M	Mono	1	1	no		1 phase 1 speed smoke extract. 1 speed comfort
D1C1MT	Mono	1	1	yes		1 phase 1 speed smoke extract. 1 speed comfort and thermal prot.
DP1X	Tri 230	1		no		3 phases 230V 1 speed smoke extract.
DP1V	Tri 400	1		no		3 phases 400V 1 speed smoke extract.
D1C1VT	Tri 400	1	1	yes		3 phases 400V 1 speed smoke extract. 1 speed comfort and thermal prot.
DP2I	Tri 400	2		no		3 phases 400V 2 speeds smoke extract., separate windings.
D1C2I	Tri 400	1	2	no		3 phases 400V 1 speed smoke extract. 2 speeds comfort, separate windings.
D1C2IT	Tri 400 BI	1	2	yes		3 phases 400V 1 speed smoke extract. 2 speeds comfort, separate windings and thermal prot.
D2C2IT	Tri 400 BI	2	2	yes		3 phases 400V 2 speeds smoke extract. 2 speeds comfort, separate windings and thermal prot.
DP2D	Tri 400	2		no		3 phases 400V 2 speeds smoke extract., Dahlander windings.
D1C2D	Tri 400 BD	1	2	no		3 phases 400V 1 speed smoke extract. 2 speeds Comfort, Dahlander windings.
D1C2DT	Tri 400 BD	1	2	yes		3 phases 400V 1 speed smoke extract. 2 speeds Comfort, Dahlander windings and thermal prot.
D2C2DT	Tri 400	2	2	yes		3 phases 400V 2 speeds smoke extract. 2 speeds Comfort, Dahlander windings and thermal prot.
IDC DP1V	Tri 400	1		no	yes	3 phases 400V 1 speed smoke extract. and progressive start.
IDC D1C1V	Tri 400	1	1	no	yes	3 phases 400V 1 speed smoke extract. 1 speed comfort and progressive start.
IDC D1C1VT	Tri 400	1	1	yes	yes	3 phases 400V 1 speed smoke extract. 1 speed comfort, thermal prot. and progressive start.
IDC DP2I	Tri 400	2		no	yes	3 phases 400V 2 speeds smoke extract., separate windings and progressive start.
IDC D1C2I	Tri 400	1	2	no	yes	3 phases 400V 1 speed smoke extract. 2 speeds comfort, separate windings and progressive start.
IDC D1C2IT	Tri 400	1	2	yes	yes	3 phases 400V 1 speed smoke extract. 2 speeds comfort, separate windings, thermal prot. and progressive start.
IDC D2C2IT	Tri 400	2	2	yes	yes	3 phases 400V 2 speeds smoke extract. 2 speeds Comfort, Dahlander windings, thermal prot. and progressive start